



Vinyl Lift-Up Curtain

INSTALLATION MANUAL



P.O. Box 279
Shakespeare, ON
N0B 2P0

1-800-960-4002
www.faromor.com

February 2015

Lift-Up Curtain Installation Manual

INDEX

<u>Page</u>	<u>Description</u>
2	Framing Details
3	Cutting Length Guide
4	Curtain Track Installation Top
5	Panel Installation
6	Top Pipe Installation
7	Second Panel Installation
8	Cable Sleeve Installation
9	Top Hardware
10	Bottom Hardware
11	Bottom Cabling Details
12	Top Cabling Details
13	Winch Cabling
14	End Guard Details
15	Wide Opening Requirements

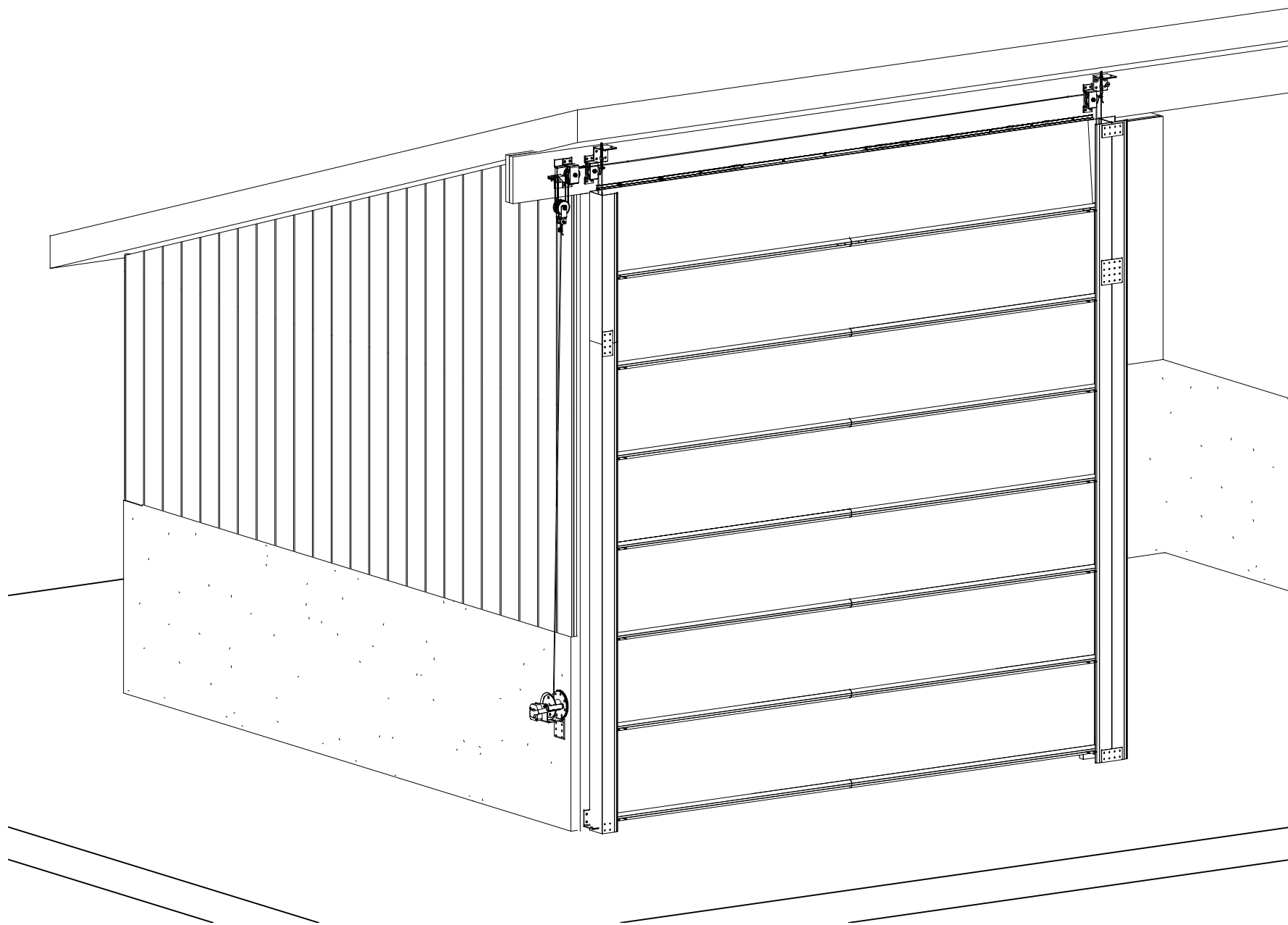

FRAMING DETAILS

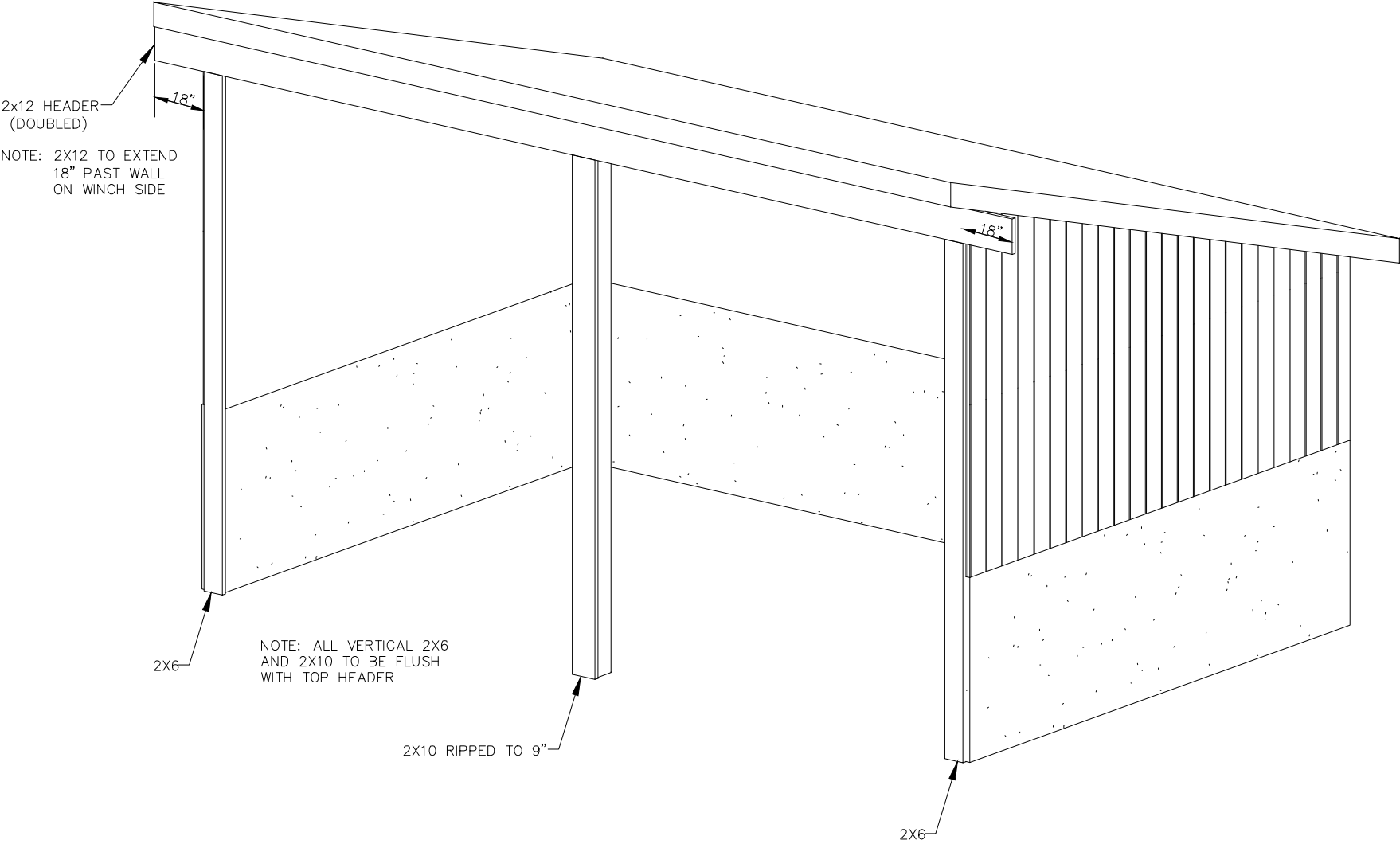

CUTTING DETAILS

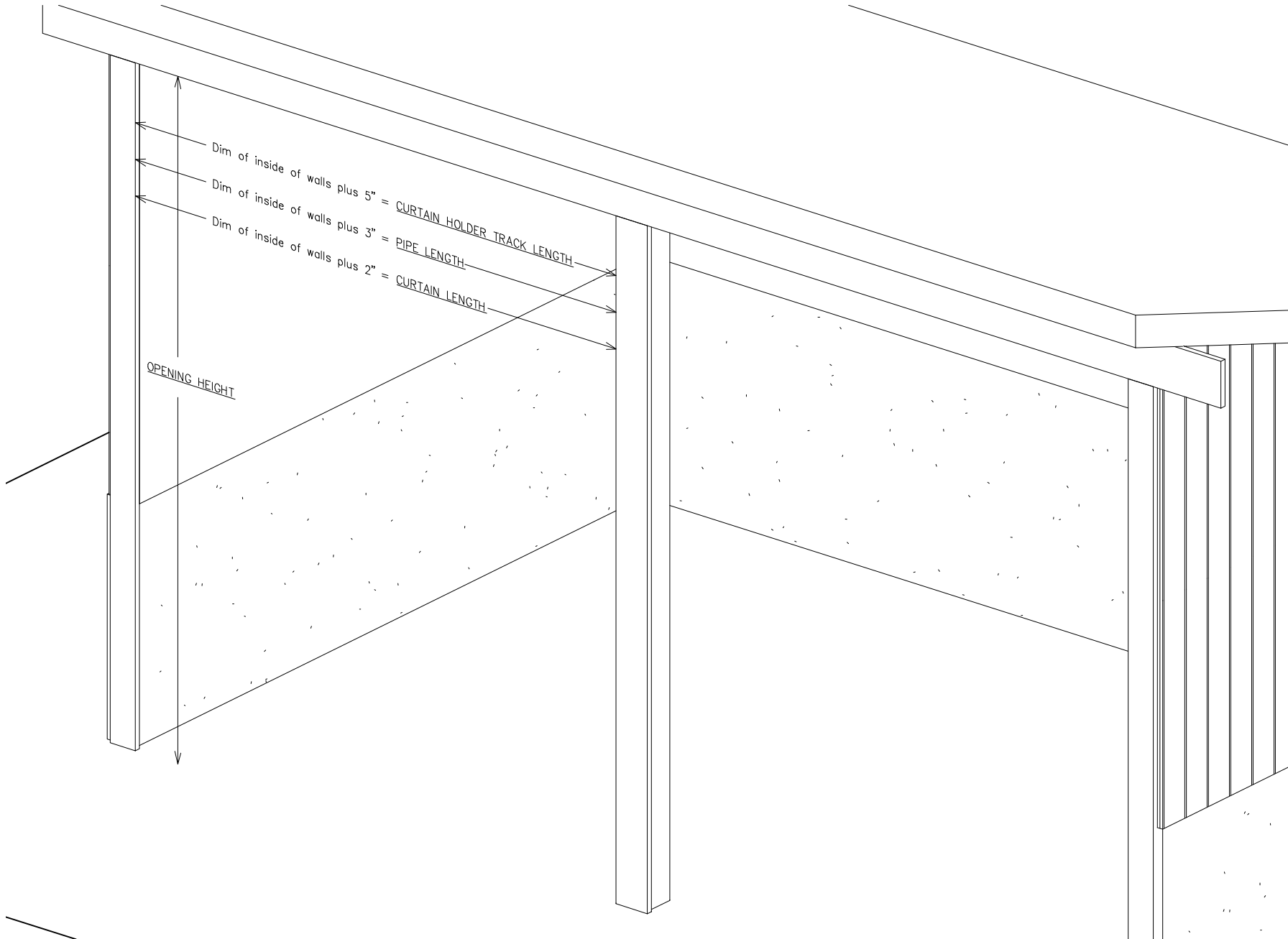

CURTAIN TRACK INSTALLATION

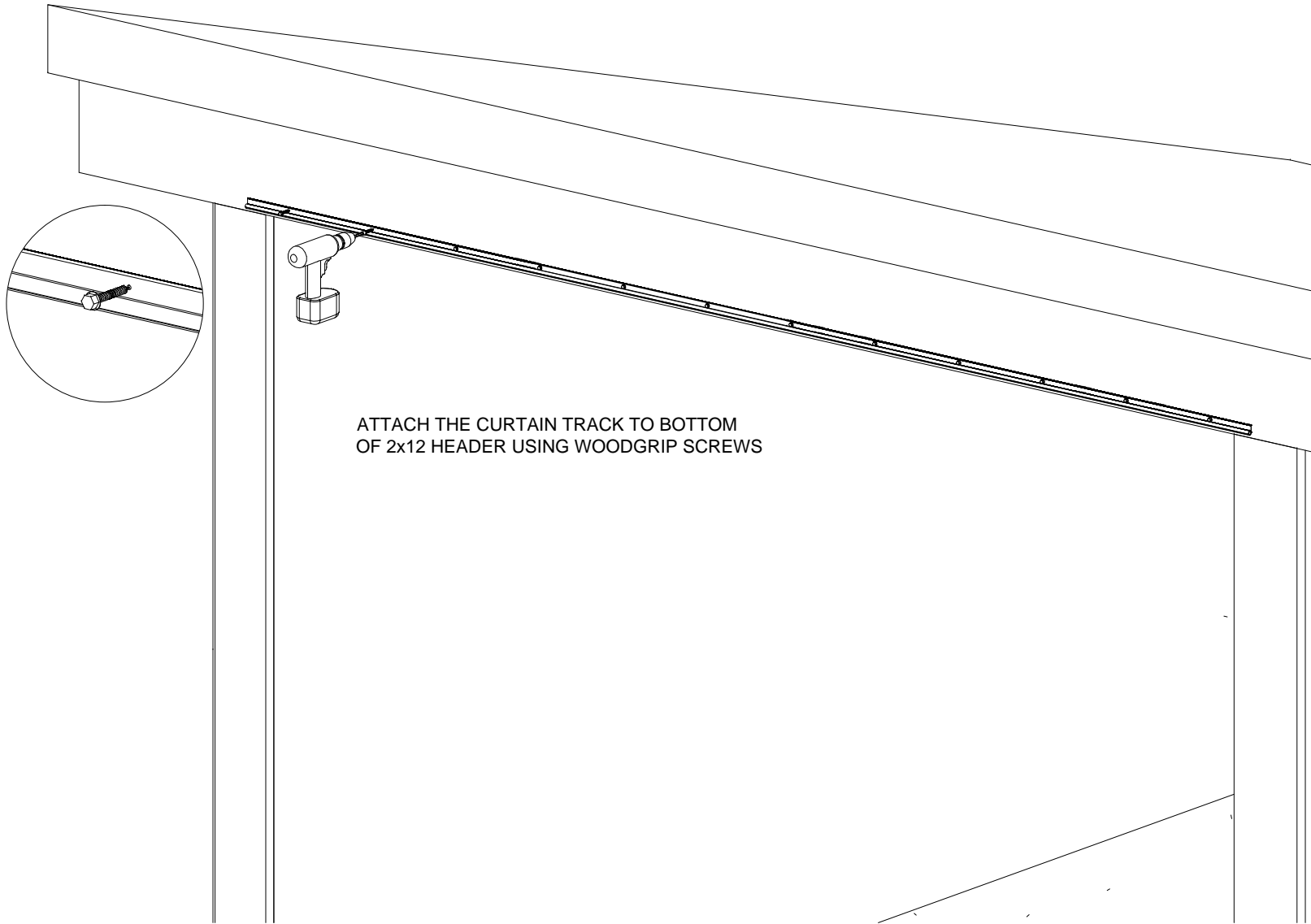

TOP PANEL INSTALLATION

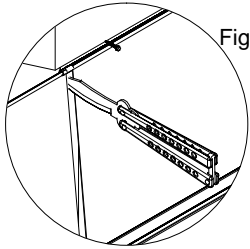

Fig. 4

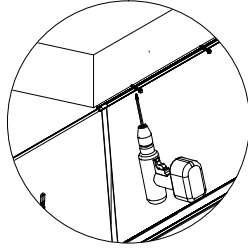
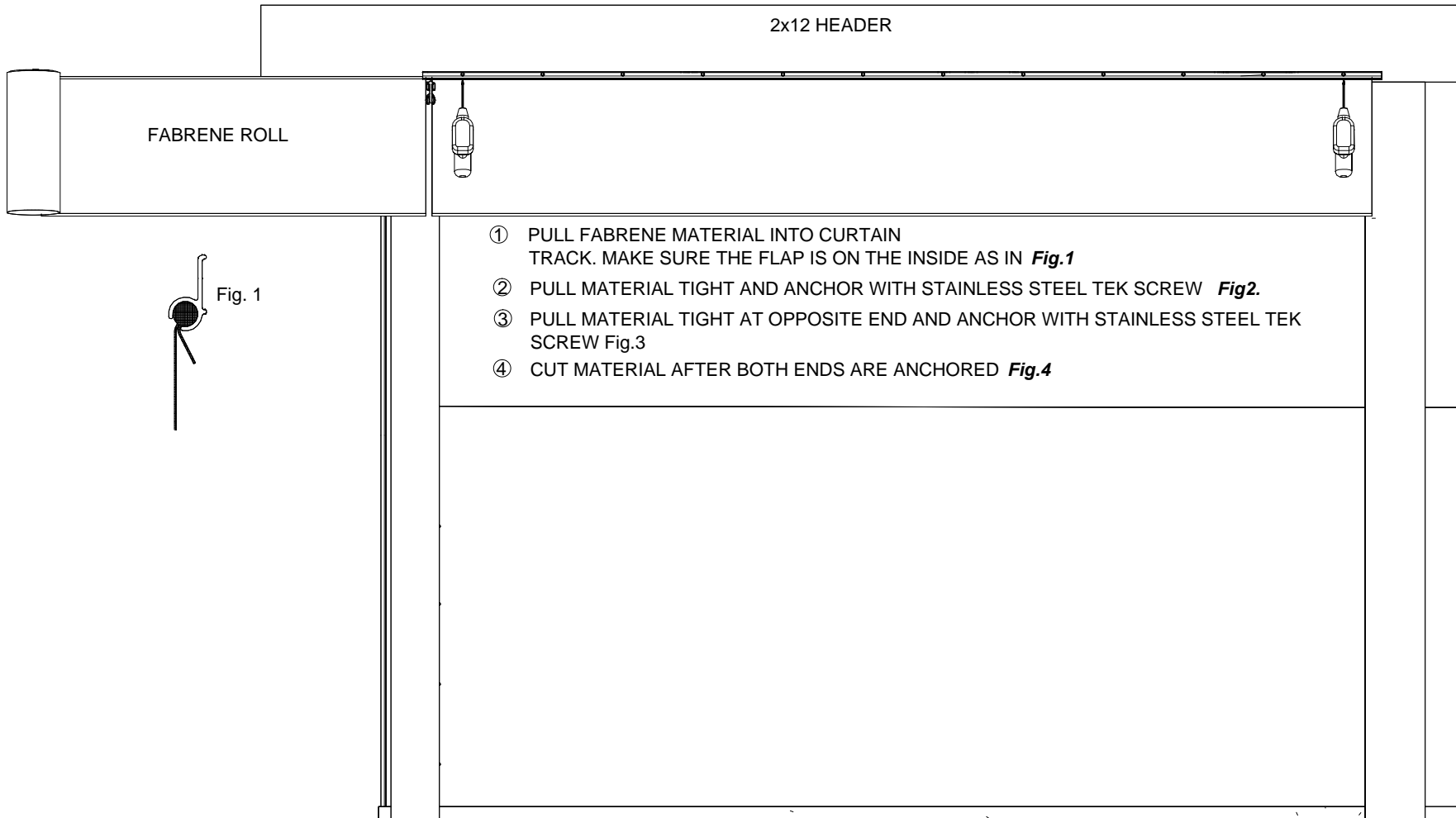
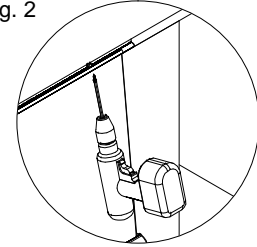
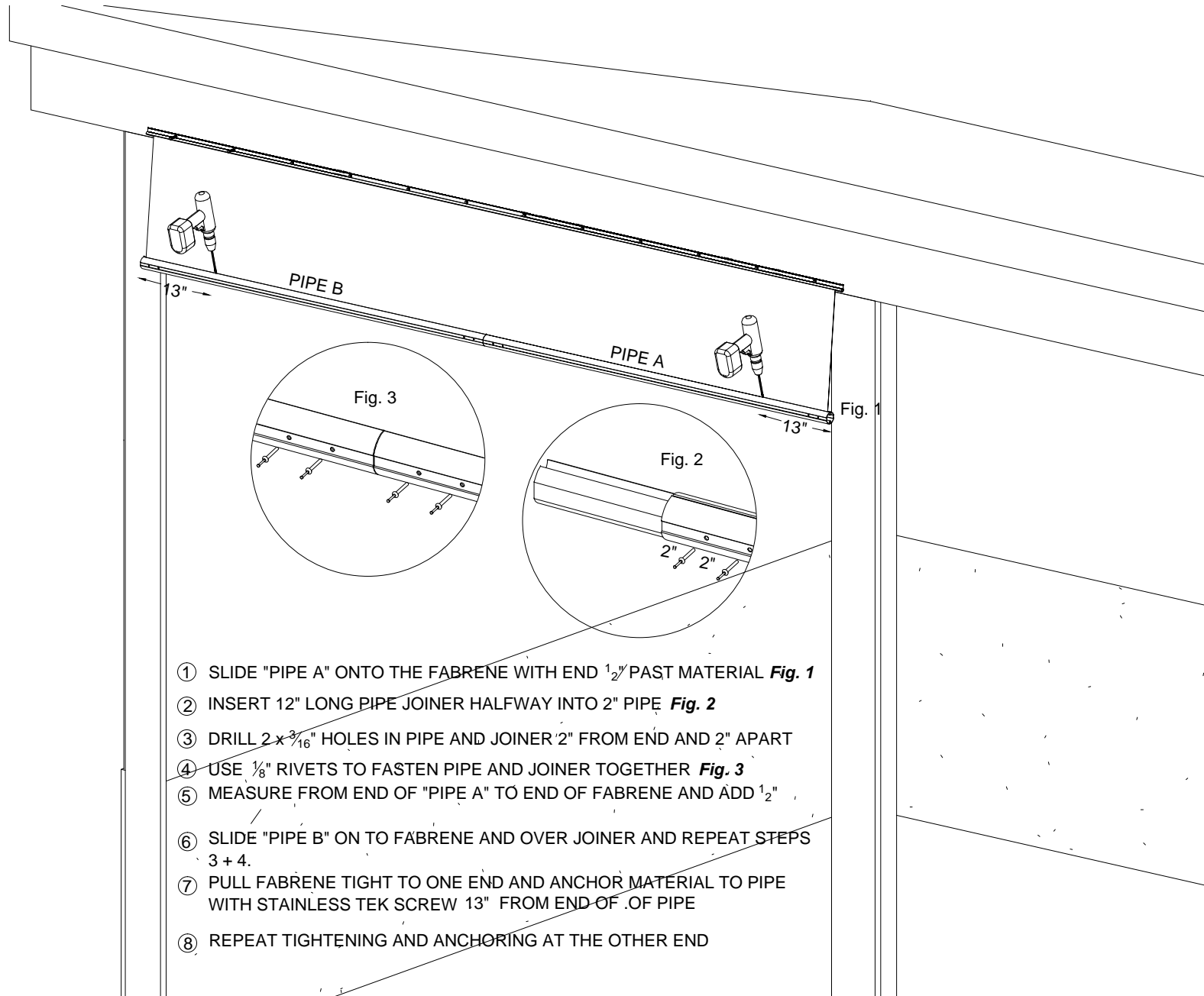

Fig. 2



TOP PIPE INSTALLATION



SECOND PANEL INSTALLATION

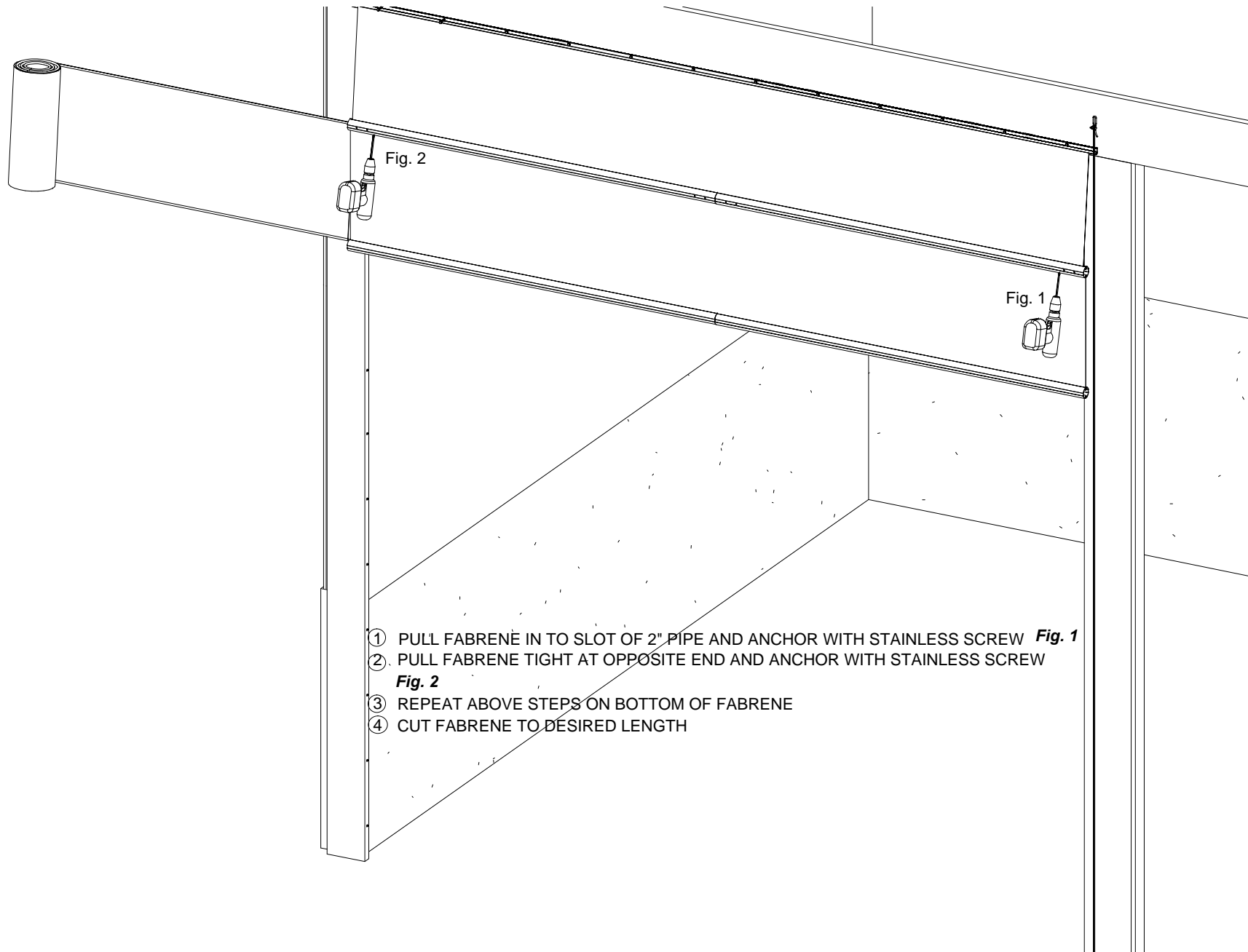

CABLE SLEEVE INSTALLATION

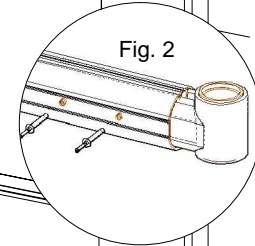
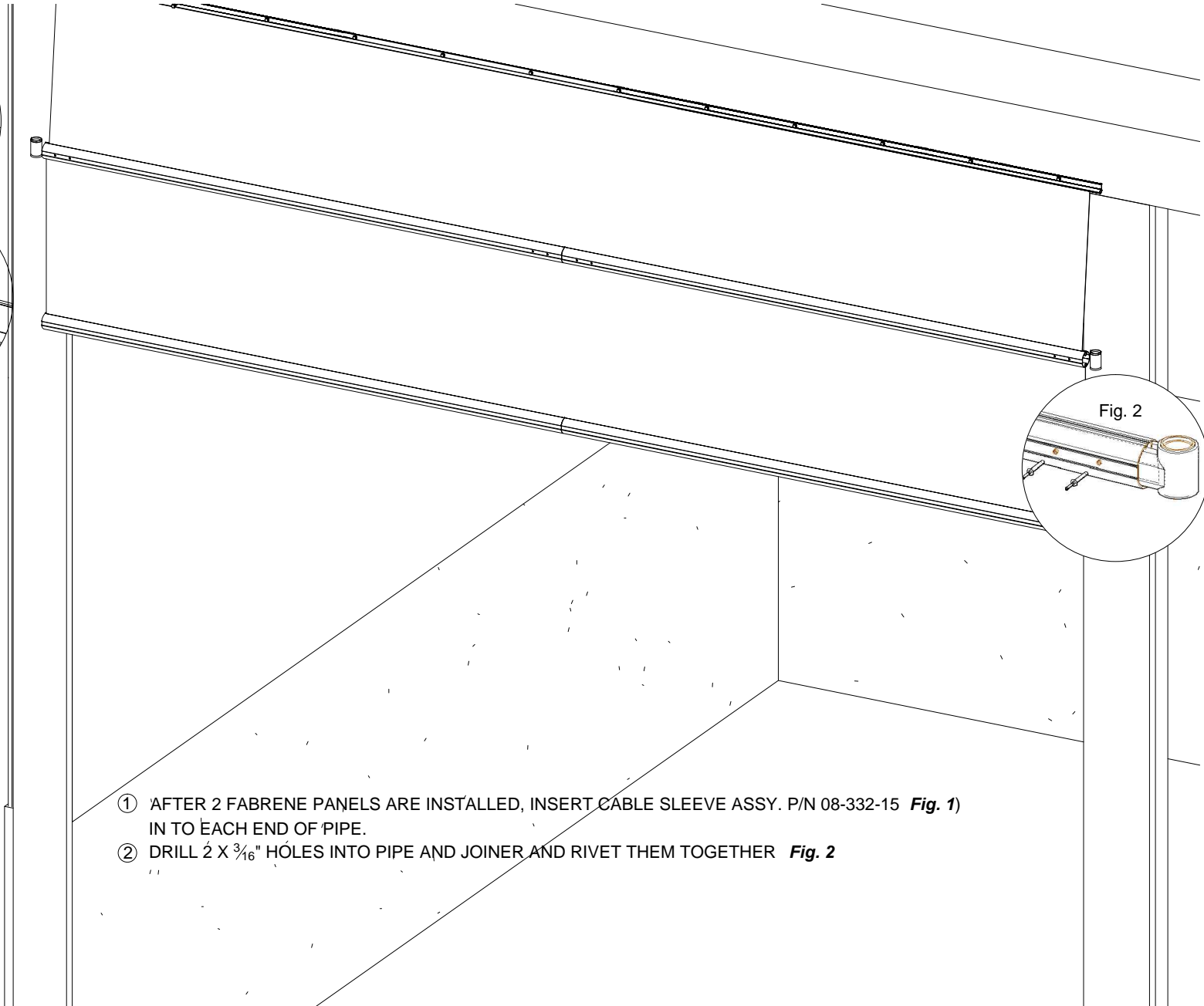
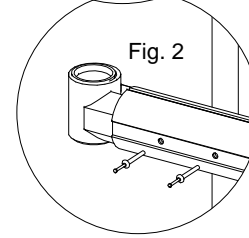
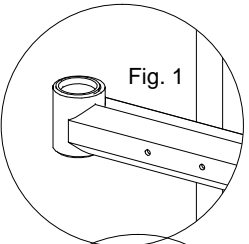

- ① AFTER 2 FABRENE PANELS ARE INSTALLED, INSERT CABLE SLEEVE ASSY. P/N 08-332-15 **Fig. 1)**
IN TO EACH END OF PIPE.
- ② DRILL 2 X $\frac{3}{16}$ " HOLES INTO PIPE AND JOINER AND RIVET THEM TOGETHER **Fig. 2**

TOP HARDWARE

08-130-37 FLUSH MOUNT PULLEY WITH DOUBLE WHEEL ASSEMBLY

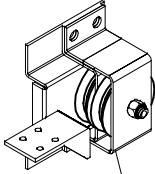

08-201-20-01 MEDIUM WINCH MOUNTING BRACKET

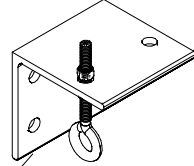

08-130-39 FLUSH MOUNT PULLEY WITH BRACKET

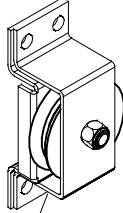

08-130-39 FLUSH MOUNT PULLEY WITH BRACKET

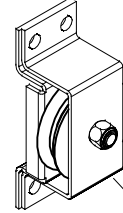

08-201-20-01 MEDIUM WINCH MOUNTING BRACKET

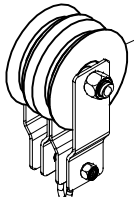
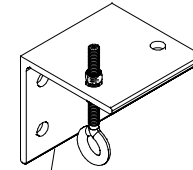

08-130-38 DOUBLE WHEEL WINCH PULLEY ASSY.

NOTE: WHEN FASTENING HARDWARE TO TOP HEADER, IT IS RECOMMENDED TO USE BOLTS THROUGH THE HEADER WITH NUTS ON THE BACKSIDE INSTEAD OF LAGS

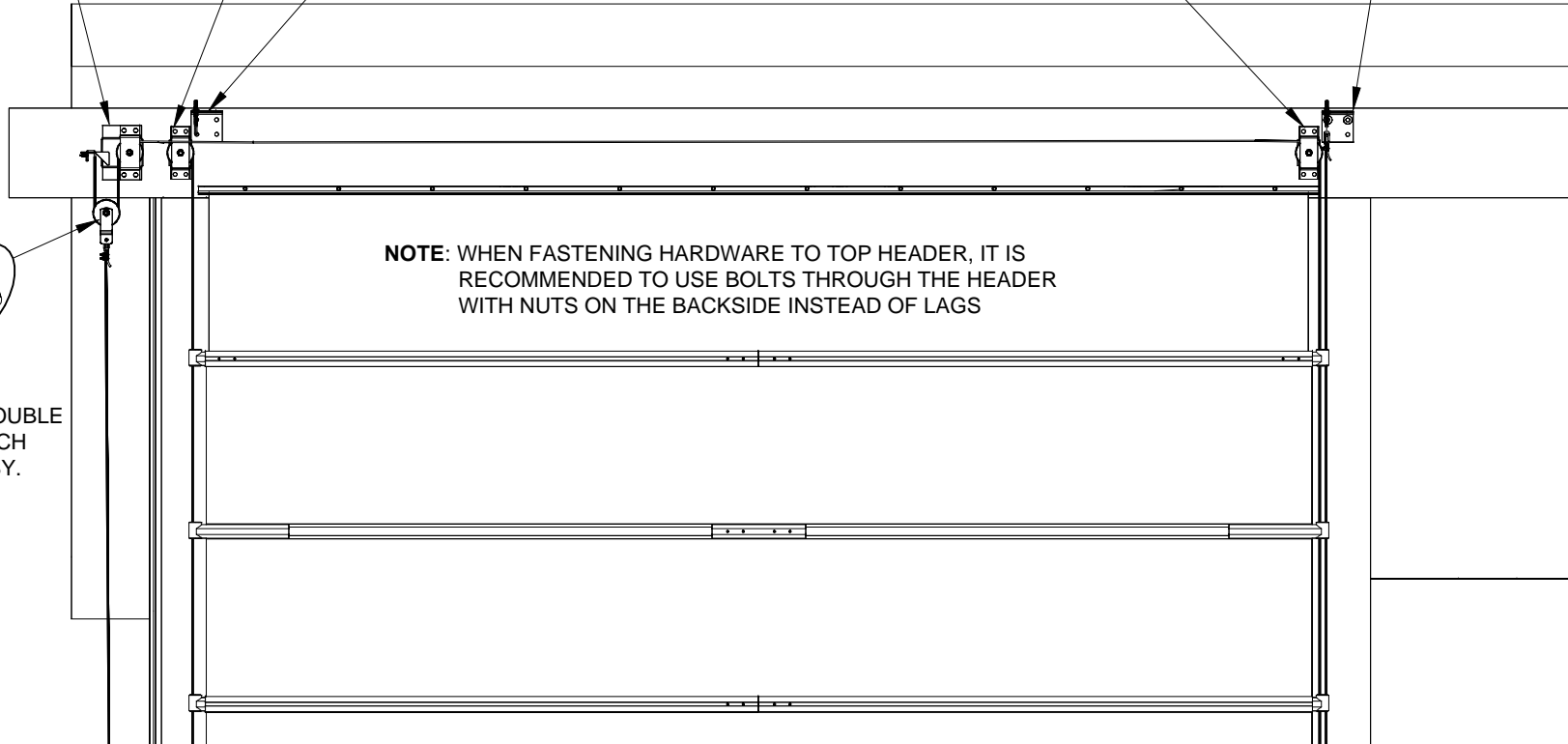

BOTTOM HARDWARE

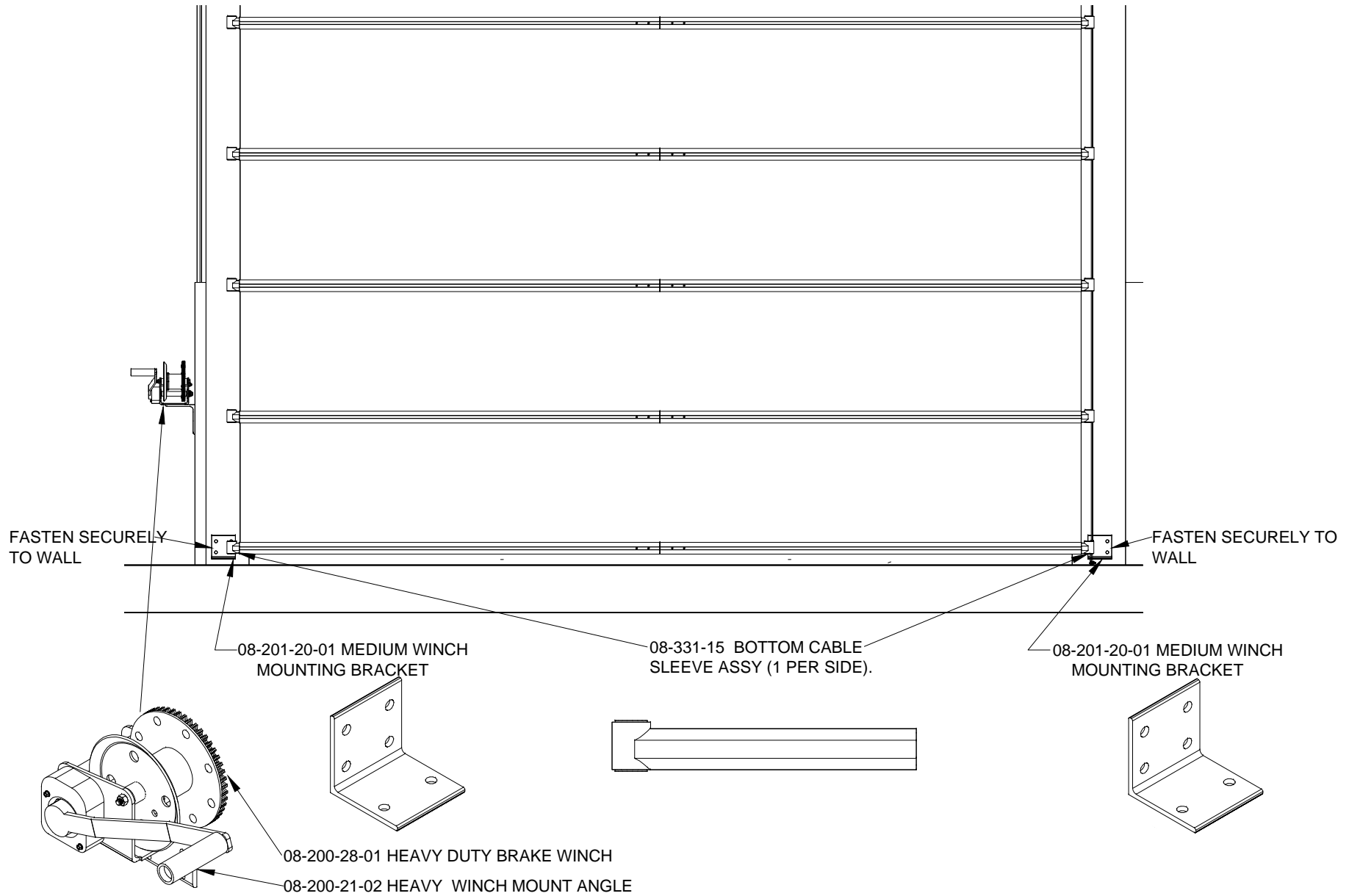

BOTTOM CABLING DETAILS

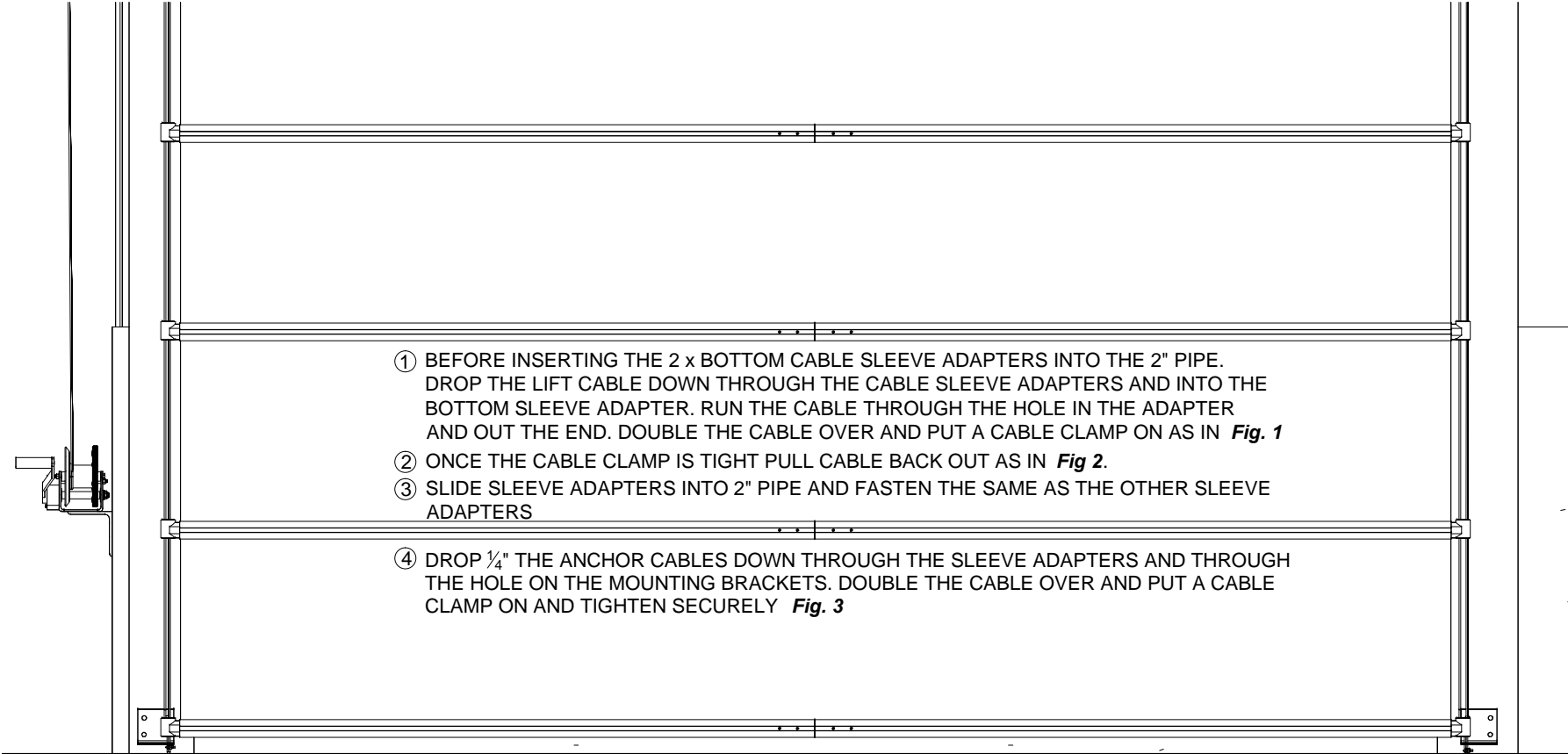
- 
- ① BEFORE INSERTING THE 2 x BOTTOM CABLE SLEEVE ADAPTERS INTO THE 2" PIPE. DROP THE LIFT CABLE DOWN THROUGH THE CABLE SLEEVE ADAPTERS AND INTO THE BOTTOM SLEEVE ADAPTER. RUN THE CABLE THROUGH THE HOLE IN THE ADAPTER AND OUT THE END. DOUBLE THE CABLE OVER AND PUT A CABLE CLAMP ON AS IN **Fig. 1**
 - ② ONCE THE CABLE CLAMP IS TIGHT PULL CABLE BACK OUT AS IN **Fig. 2**.
 - ③ SLIDE SLEEVE ADAPTERS INTO 2" PIPE AND FASTEN THE SAME AS THE OTHER SLEEVE ADAPTERS
 - ④ DROP $\frac{1}{4}$ " THE ANCHOR CABLES DOWN THROUGH THE SLEEVE ADAPTERS AND THROUGH THE HOLE ON THE MOUNTING BRACKETS. DOUBLE THE CABLE OVER AND PUT A CABLE CLAMP ON AND TIGHTEN SECURELY **Fig. 3**

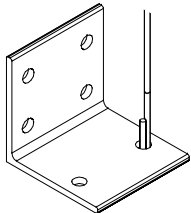
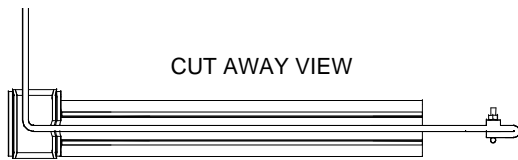
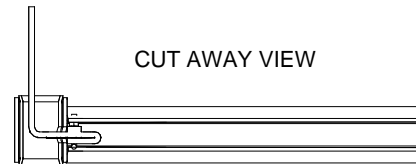

Fig. 3



CUT AWAY VIEW

Fig. 1



CUT AWAY VIEW

Fig. 2

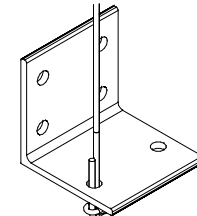

Fig. 3

TOP CABLING DETAILS

Fig. 6

Fig. 3

Fig. 1

Fig. 4

Fig. 5

Fig. 4

Fig. 2

Fig. 1

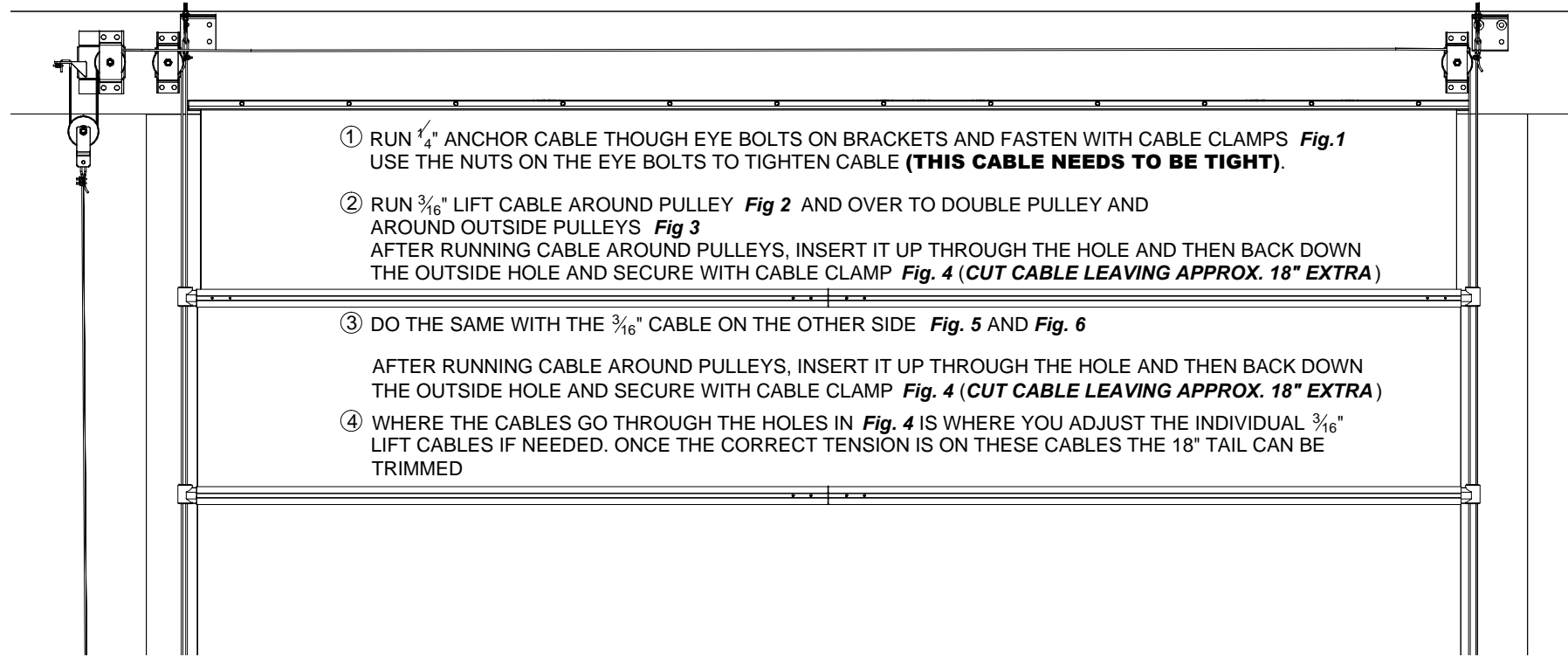
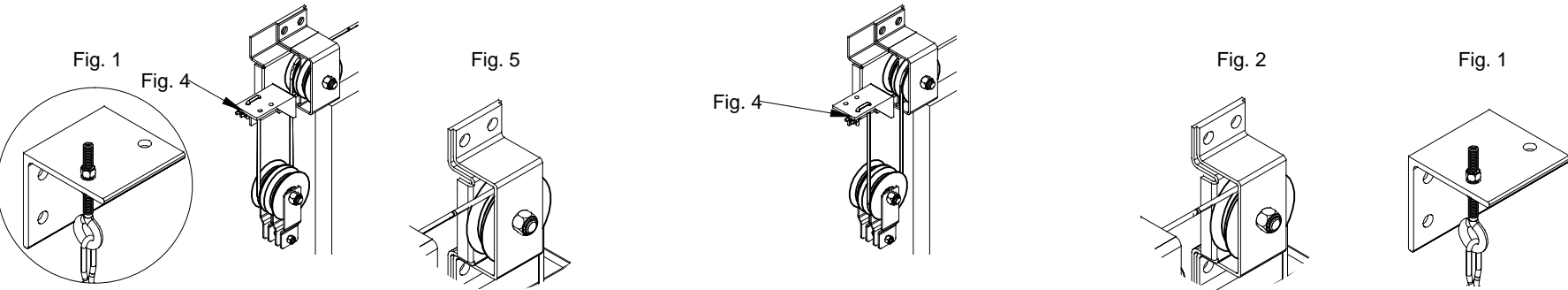

- ① RUN $\frac{1}{4}$ " ANCHOR CABLE THROUGH EYE BOLTS ON BRACKETS AND FASTEN WITH CABLE CLAMPS *Fig.1*
USE THE NUTS ON THE EYE BOLTS TO TIGHTEN CABLE (**THIS CABLE NEEDS TO BE TIGHT**).
- ② RUN $\frac{3}{16}$ " LIFT CABLE AROUND PULLEY *Fig 2* AND OVER TO DOUBLE PULLEY AND
AROUND OUTSIDE PULLEYS *Fig 3*
AFTER RUNNING CABLE AROUND PULLEYS, INSERT IT UP THROUGH THE HOLE AND THEN BACK DOWN
THE OUTSIDE HOLE AND SECURE WITH CABLE CLAMP *Fig. 4* (**CUT CABLE LEAVING APPROX. 18" EXTRA**)
- ③ DO THE SAME WITH THE $\frac{3}{16}$ " CABLE ON THE OTHER SIDE *Fig. 5* AND *Fig. 6*
AFTER RUNNING CABLE AROUND PULLEYS, INSERT IT UP THROUGH THE HOLE AND THEN BACK DOWN
THE OUTSIDE HOLE AND SECURE WITH CABLE CLAMP *Fig. 4* (**CUT CABLE LEAVING APPROX. 18" EXTRA**)
- ④ WHERE THE CABLES GO THROUGH THE HOLES IN *Fig. 4* IS WHERE YOU ADJUST THE INDIVIDUAL $\frac{3}{16}$ "
LIFT CABLES IF NEEDED. ONCE THE CORRECT TENSION IS ON THESE CABLES THE 18" TAIL CAN BE
TRIMMED

WINCH CABLING

Fig. 1

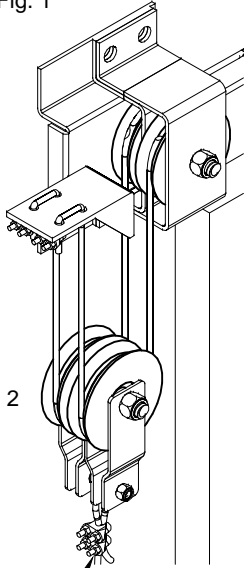
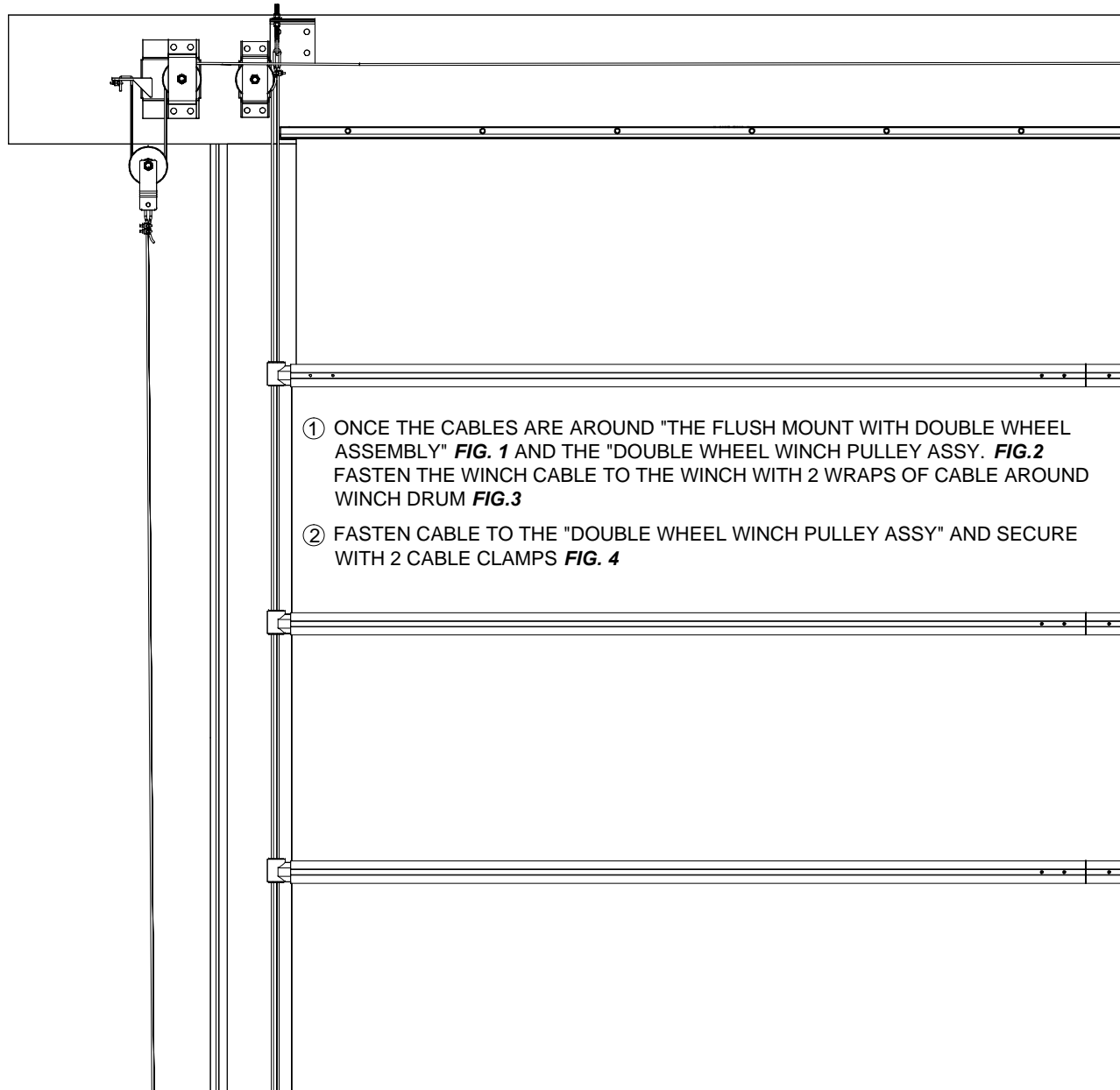
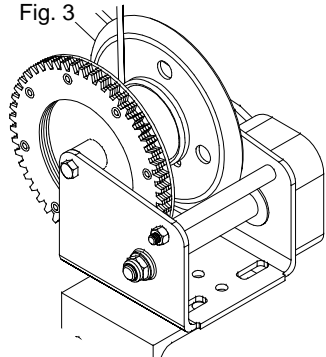

Fig. 2

Fig. 4

Fig. 3



- ① ONCE THE CABLES ARE AROUND "THE FLUSH MOUNT WITH DOUBLE WHEEL ASSEMBLY" **FIG. 1** AND THE "DOUBLE WHEEL WINCH PULLEY ASSY. **FIG. 2** FASTEN THE WINCH CABLE TO THE WINCH WITH 2 WRAPS OF CABLE AROUND WINCH DRUM **FIG. 3**
- ② FASTEN CABLE TO THE "DOUBLE WHEEL WINCH PULLEY ASSY" AND SECURE WITH 2 CABLE CLAMPS **FIG. 4**

END GUARD INSTALLATION

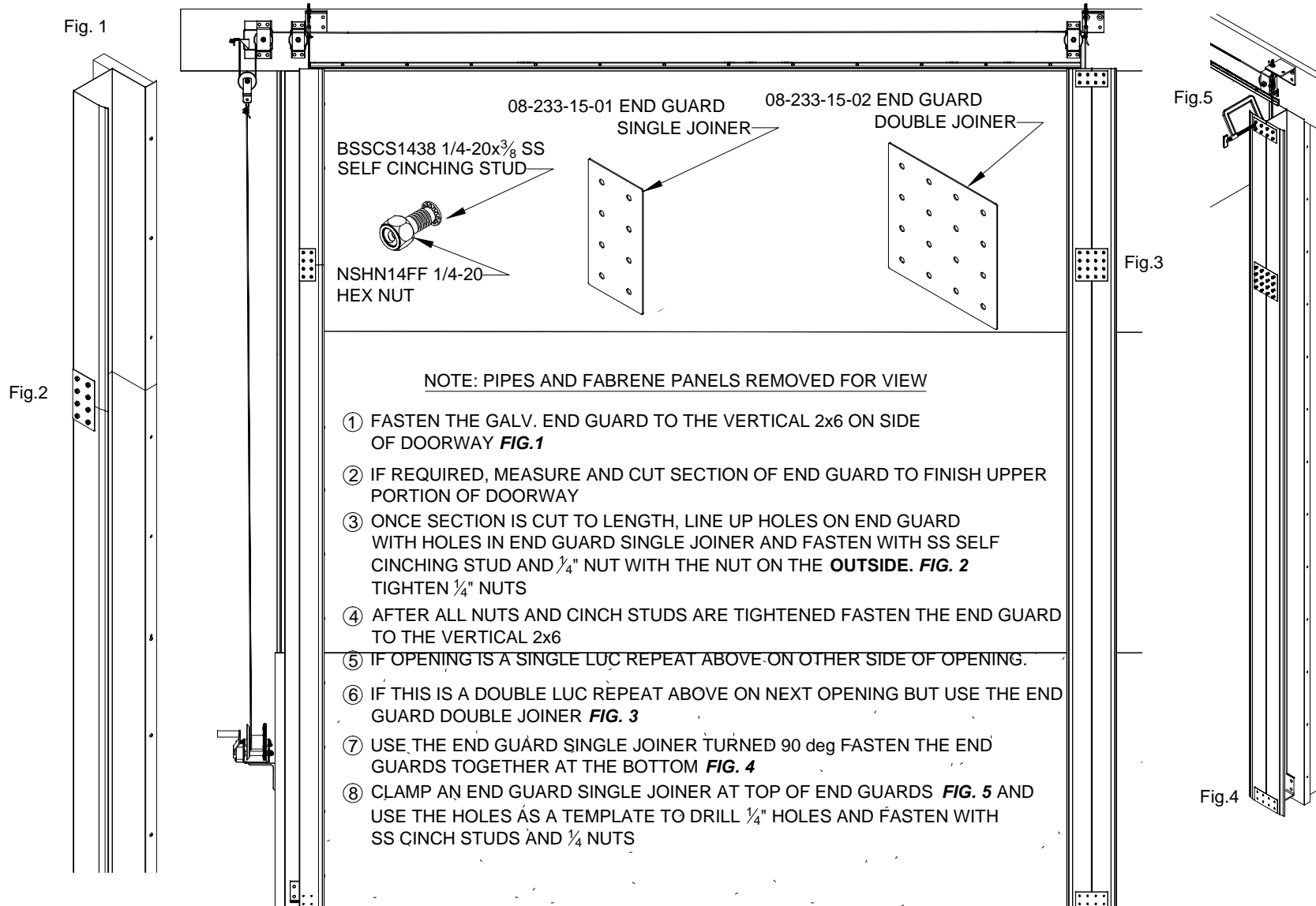

WIDE OPENING REQUIREMENTS

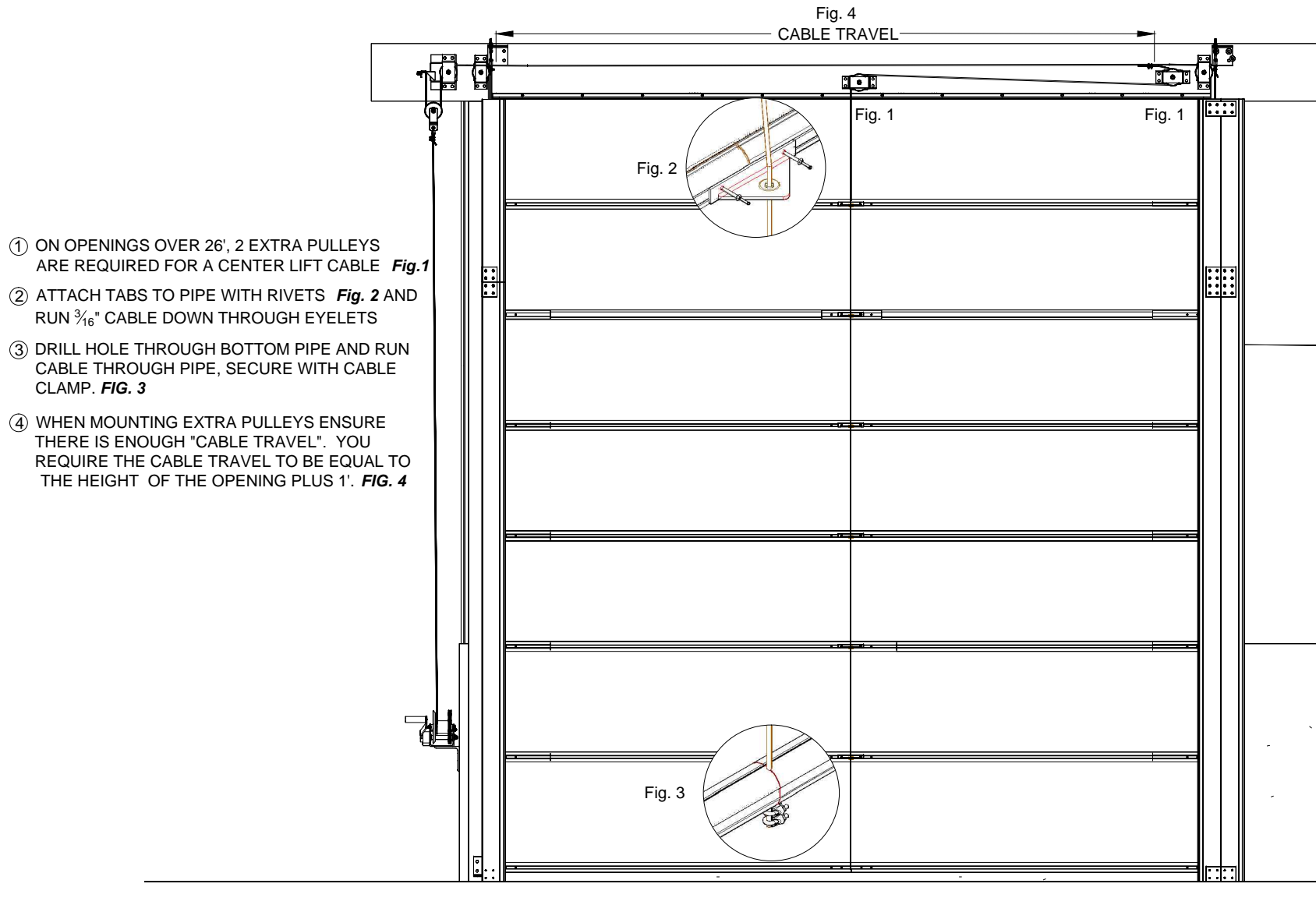

CURTAIN SYSTEMS SAFETY PRECAUTIONS

NOTE: ALL INSTALLATION OF ELECTRICAL CONTROLS SHOULD BE DONE BY A QUALIFIED ELECTRICIAN.

General Operation

- Curtains should only be operated when the owner or other responsible persons are in the facility.
- Unauthorized persons or small children should not be near or have access to the outside or inside automatic/manual drive units as they may result in injury. Do not attempt to stop any automatic drive unit by hand while it is in operation.
- Do not attempt to adjust cables or pulleys while system is in operation.
- When making adjustments to automatic drive units, ensure that the override switch is in the “off” position so that the curtain cannot start while any work is being completed.

Protective Covering

- Ensure that all drive units (manual or automatic) have the covers installed where applicable.
- Electrical motors mounted on outside of building should be covered to prevent damage.

CURTAIN SYSTEMS MAINTENANCE

RAW/BRU/STD/STDS

- All cables (main and pull-ups) should be checked on a monthly basis to ensure proper operation. Over time, some cables may stretch causing uneven pull up of curtain system. Where necessary, loosen cable clamp, pull cable tight and re-fasten clamp when curtain is level.
- Ensure all cable clamps are tightly secured so it does not result in drop cables coming loose.
- Ensure curtains remain pulled tight from one end to the other. If curtain seems to be bunching or creasing, curtain may need to be tightened.
- Check all pulleys for excess wear on wheels that may cause cable to get caught.
- Periodically check over aluminum tubes to ensure they are connected tightly.
- Check end pockets to ensure all nuts and bolts are tightly secured.
- Tighten windropes as necessary to make sure there is no slack.
- For bottom roll-up systems, ensure aluminum track is clear of any debris and that gearbox wheels are turning smoothly.

PRC

- Ensure all mounting brackets are secured tightly to wall and to end of aluminum tube.
- Periodically check that center support rollers are rolling properly and not seized.
- If applicable, ensure valance does not get caught in roller tube.
- Check for wear on sidewall seals periodically if heavy cow traffic is an issue.

NOTE: FOR ANY SERVICE ON THERMOSTATS OR AUTOMATIC DRIVE UNITS, PLEASE CONTACT A FAROMOR SERVICE REPRESENTATIVE FOR ASSISTANCE. FOR ADJUSTMENT OF LIMIT SWITCHES SEE INSTALLATION MANUALS – ELECTRICAL SECTION.

General Cleaning:

- Use mild soap or detergents for cleaning any of our Faromor products – do not use solvents or aggressive cleaning agents.
- High pressure washers can be used on all products but maintain a minimum distance from product of approximately 1m so as not to put too much pressure on the material – especially fabric curtains.
- Ensure rolling curtains are in the fully closed position when washing so that excess water does not get caught in the rolls of the fabric – allow the water to run completely off the curtains.
- Avoid direct pressure on any curtain area that has an existing hole or ClearVu panel that has an existing crack – the added water pressure may cause more damage at those locations.
- **FOR DRIVE UNITS** – it is recommended to do a simple hand cleaning of the units with warm water and avoid excess water around the motor, wiring or vent plugs so no water will enter the gears or damage the wiring – this will cause premature failure.

NOTE: DO NOT USE HIGH PRESSURE WASHERS OR WATER OF ANY KIND TO CLEAN DRIVE UNITS OR THERMOSTATS – THIS WILL DAMAGE THE UNITS.