

# SIS SERIES

An economical fresh air supply unit designed as a practical method to meet NFPA 96 separation requirements between supply & exhaust air streams in restaurant applications. Also suitable for many other applications, such as schools and apartments.

## TYPICAL INSTALLATION

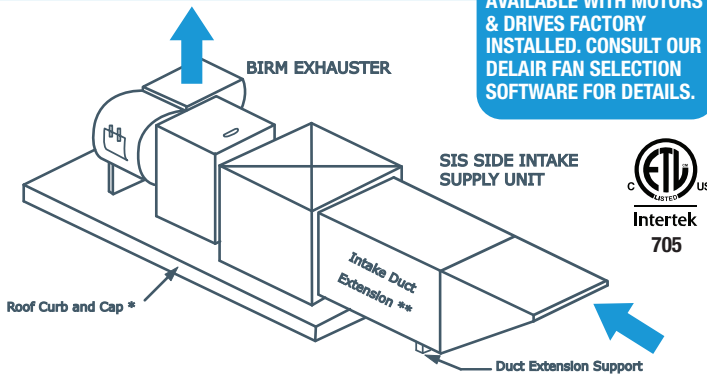

## FEATURES

- Easy on-site addition of customer supplied air supply duct extension between the intake hood and unit provides additional separation where necessary.
- Filters designed with large surface area for efficient filtration.
- Grey weather resistant baked powder coat finish.
- Weather proof cabinet designed for outdoor roof mounting.
- Flexible forward curved belt drive blowers operate at low speed and low noise levels.
- Heavy duty ball bearings suitable for -65° to +250° F.
- Washable aluminum mesh filter are located in the intake hood (except SIS-20) and are accessible through the hood end cap for ease of service.
- SIS-20 has a drawer type filter section (not illustrated). The SIS-20 intake hood has a screened inlet.



Canarm certifies that the SIS Series shown herein are licensed to bear the AMCA Seal. The ratings shown are based on tests and procedures performed in accordance with AMCA Publications 211 & 311 and comply with the requirements of the AMCA Certified Ratings Programme. The AMCA certified ratings seal applies to air and sound performance only. The SIS Series shown herein are not approved by AMCA for FEI ratings.

## PERFORMANCE SPECIFICATIONS

MODEL	1/2" SP				1" SP				1 1/2" SP				2" SP				2 1/2" SP				Min HP	Max HP
	CFM	BHP	FEI	FEPact (kW)	CFM	BHP	FEI	FEPact (kW)	CFM	BHP	FEI	FEPact (kW)	CFM	BHP	FEI	FEPact (kW)	CFM	BHP	FEI	FEPact (kW)		
SIS-9	2300	1.36	0.64	1.30	2200	1.48	0.74	1.40	2000	1.47	0.84	1.39	1800	1.45	0.91	1.37	1600	1.45	0.96	1.37	1/4	1 1/2
SIS-10	2700	1.46	0.67	1.38	2400	1.42	0.79	1.35	2200	1.49	0.87	1.41	1900	1.40	0.96	1.33	1700	1.44	0.99	1.37	1/4	1 1/2
SIS-12	3600	1.94	0.62	1.80	3300	1.98	0.75	1.83	2900	1.90	0.86	1.76	2600	1.96	0.91	1.81	2100	1.94	0.88	1.80	1/4	2
SIS-15	5300	2.98	0.61	2.68	4800	2.88	0.74	2.59	4400	2.90	0.85	2.61	3900	2.91	0.90	2.62	3500	3.00	0.92	2.70	1/2	3
SIS-18	8300	4.95	0.60	4.33	7700	4.86	0.73	4.26	7100	4.97	0.81	4.35	6500	4.93	0.89	4.32	5800	4.94	0.93	4.32	1/2	5
SIS-20	12500	9.91	0.46	8.45	11700	9.83	0.56	8.38	11000	9.89	0.64	8.43	10300	9.94	0.71	8.48	9500	9.90	0.76	8.48	2	10

Power rating (BHP) does not include transmission losses. Performance certified is for installation type B: Free inlet, Ducted outlet.

Performance ratings do not include the effect of apertures (accessories).

FOR FAN CURVES & FULL PERFORMANCE DATA, CONSULT OUR DELAIR SOFTWARE. [WWW.CANARM.COM/DELAIR](http://WWW.CANARM.COM/DELAIR)



View FEI charts  
[canarm.com/fei-sis](http://canarm.com/fei-sis)

## DIMENSIONS

MODEL	A	B	D	E	F	G	H	L	M	Z	FILTERS		*INSIDE CABINET	UNIT WEIGHT (LBS) (without motors & drives)
											SIZE	QUANTITY		
SIS-9	24 3/8"	19 3/8"	10 1/4"	11 13/16"	6 9/32"	7 1/16"	7 1/16"	19 1/4"	16 9/16"	21 1/4"	16" x 24" x 1"	1	24"x 24"	70
SIS-10	28 3/8"	21 3/8"	11 3/8"	13 1/8"	7 5/8"	8 1/2"	8 1/2"	20 1/2"	18 9/16"	25 3/4"	15" x 20" x 1"	2	28"x 28"	87
SIS-12	32 3/8"	24 5/8"	13 7/16"	15 5/8"	8 3/8"	9 15/32"	9 15/32"	25 3/8"	21 9/16"	30 3/4"	20" x 25" x 1" & 16" x 25" x 1"	1 & 1	32"x 32"	117
SIS-15	36 3/8"	28 3/8"	15 7/8"	18 5/8"	8 7/8"	8"	12 1/2"	31 3/16"	25 13/16"	33 1/2"	20" x 28 1/2" x 1"	2	36"x 36"	175
SIS-18	36 3/8"	42 1/2"	18 7/8"	21 7/8"	7 1/4"	6 1/4"	11 1/4"	35 5/8"	32 11/16"	40 1/4"	20" x 25" x 1" & 16" x 25" x 1"	2 & 2	36"x 36"	262
SIS-20	44 3/8"	49"	24 3/4"	24 3/4"	9 13/16"	5 3/16"	14 7/16"	38 5/8"	35 9/16"	45 1/2"***	20" x 25" x 1"	6	44"x 44"	497

\* Curb size to be smaller than inside cabinet to allow for flashing and roofing.

\*\* Includes filter section.

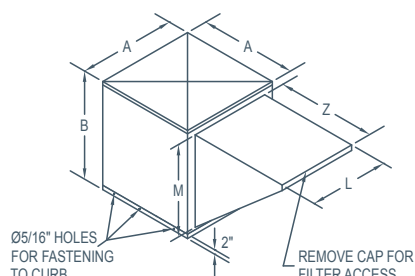
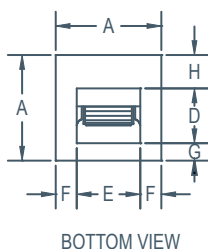

EASY TO SERVICE.  
LATCHED TOP COVER  
PROVIDES  
CONVENIENT ACCESS  
TO MOTOR, PULLEYS  
AND BELT.



## ACCESSORIES

- Roof curbs