

NOTES:

REV DESC.

REVISION HISTORY

MODIFIED BY

DATE CHECKED
3/25/2021 1:21:26 PM

Installation Instruction for handle turning 180deg

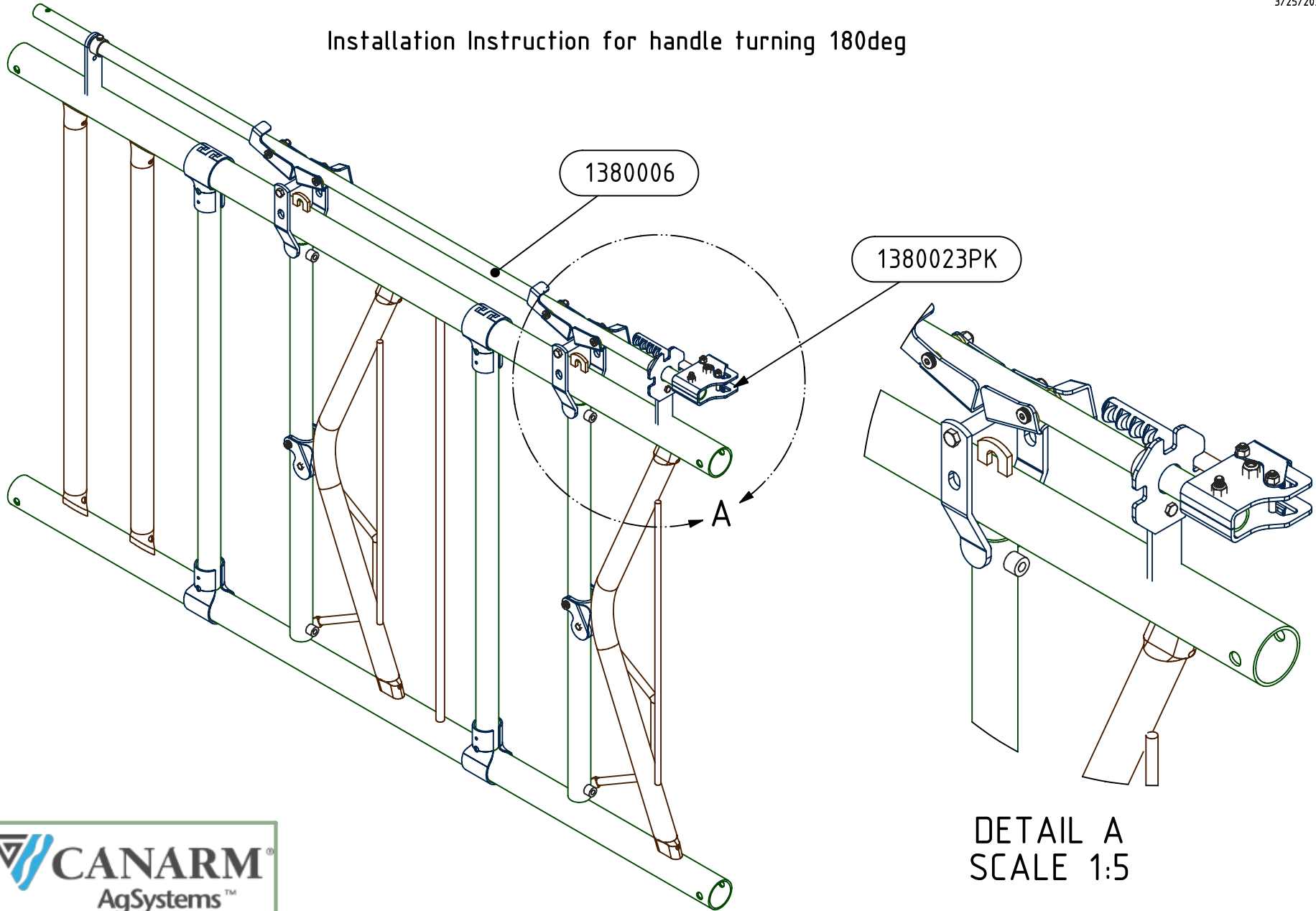

DETAIL A
SCALE 1:5



MATERIAL TYPE	Unknown Material
FINISH	
CURRENT REVISION	

INIT	DATE
	2/16/2021 12:24:24 PM

PART DESC	180deg Self Lock Handle Instruction
DWG NO.	M0119B
STD. TOLERANCES:	[+1/16" / -1/16"]
Unless Otherwise Specified All Drawing Units are In INCHES	

THIRD ANGLE PROJECTION

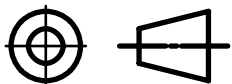

STEP 1: Redrill small existing hole in the turn rail with a 3/8" drill bit.
Slide Mount Bracket onto the turn rail and attach Mount Bracket using the 1/4"x1" Hex Bolt and 1/4" Lock Nut

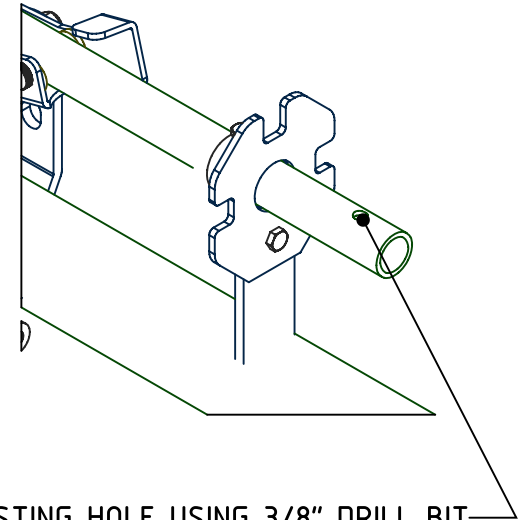
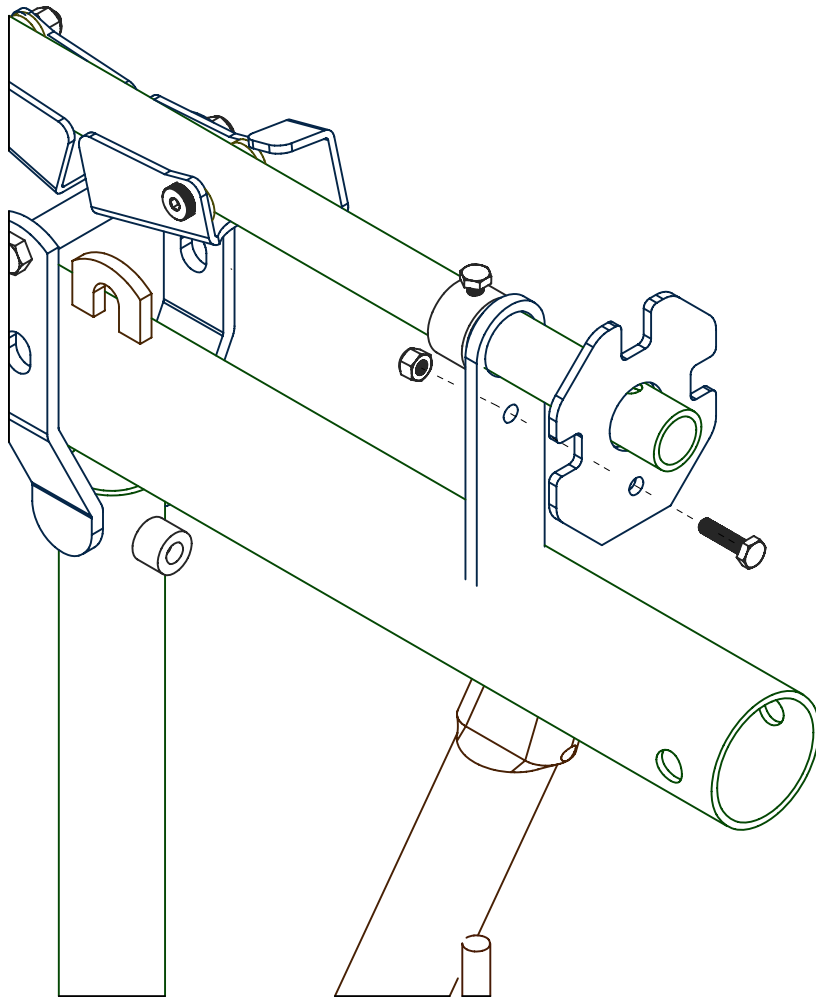

REDRILL SMALL EXISTING HOLE USING 3/8" DRILL BIT



PUTTING INNOVATION TO WORK

PART DESC

180deg Self Lock Handle Instruction

DWG NO.

M0119B

STD. TOLERANCES:

[+1/16" / -1/16"]

Unless Otherwise Specified
All Drawing Units are In
INCHES

Pg2

STEP 2: NOTE: Install brackets facing into the Cow and with the flippers facing downward.

Loosely install the left and right bracket onto the turn rail using the 5/16"x2" Hex Bolt and 5/16" Lock Nut.
Do not tighten the bolt until the next step

Note bracket orientation

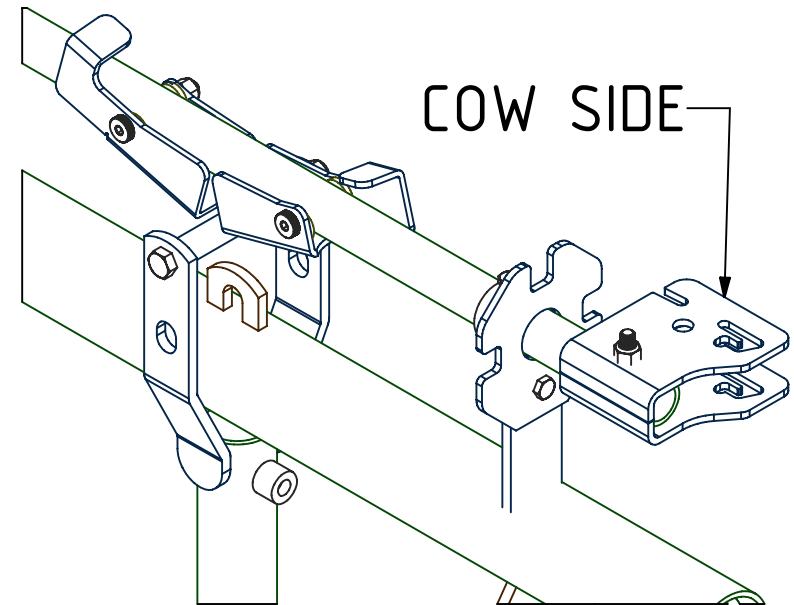
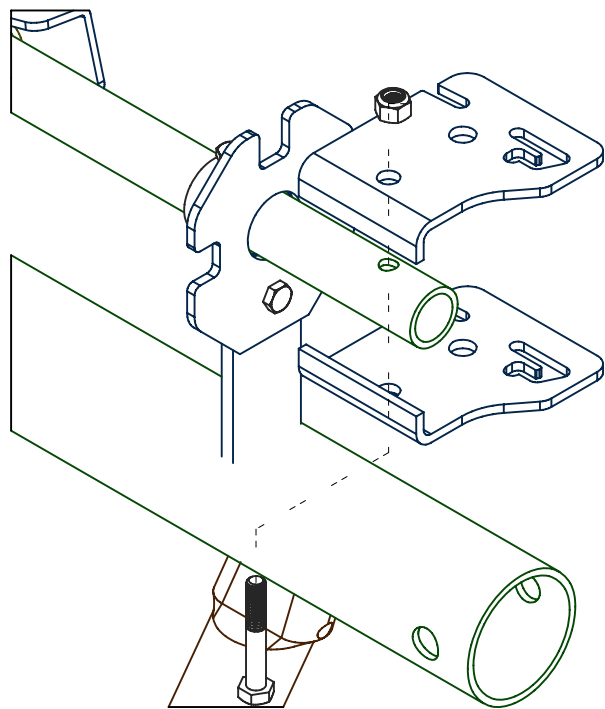

PUTTING INNOVATION TO WORK

PART DESC

180deg Self Lock Handle Instruction

DWG NO.

M0119B

STD. TOLERANCES:

[+1/16" / -1/16"]

Unless Otherwise Specified
All Drawing Units are In
INCHES

Pg3

STEP 3: Loosely attach the handle between the left and right bracket using the 3/8"x2" Hex Bolt and 3/8" Lock Nut.
Fully tighten the 5/16" bolt from Step 2.
Tighten the 3/8" bolt until the handle is snug.

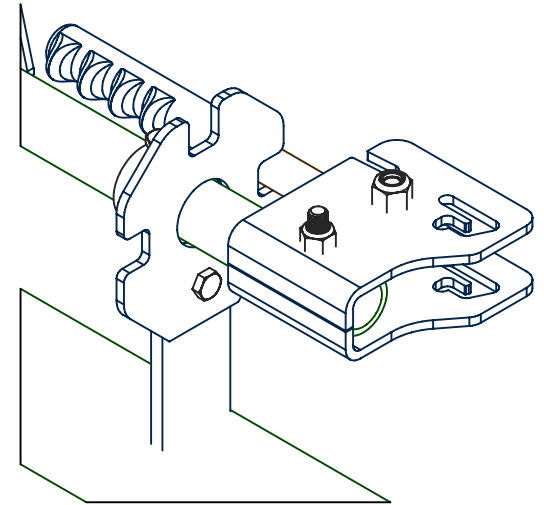
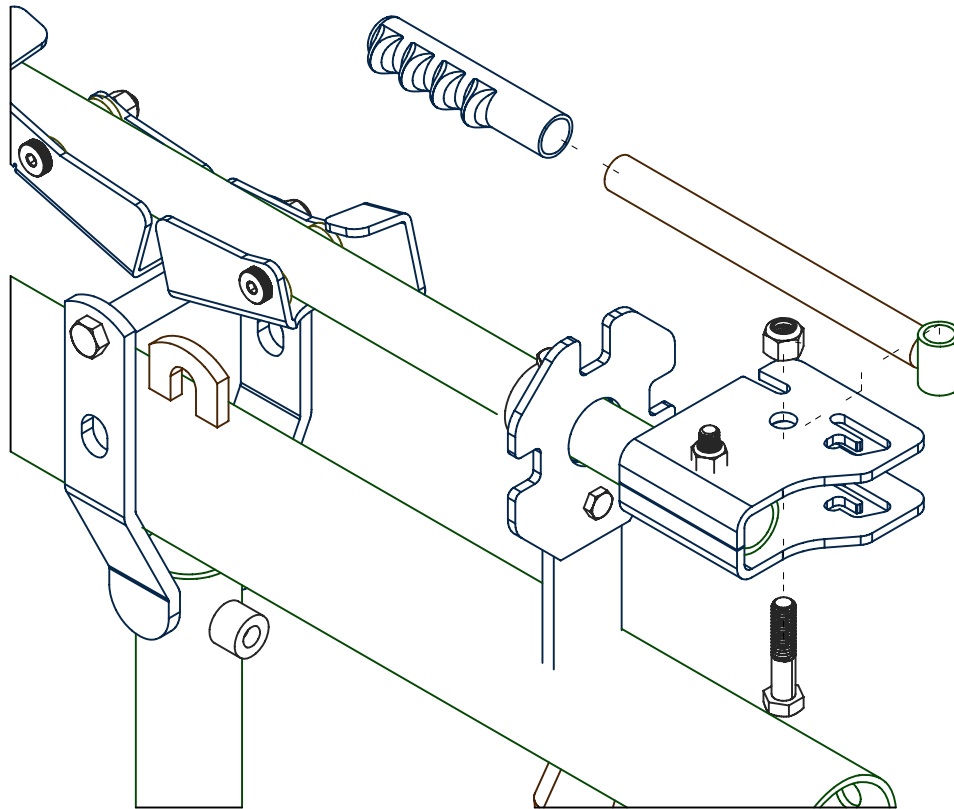

PUTTING INNOVATION TO WORK

PART DESC

180deg Self Lock Handle Instruction

DWG NO.

M0119B

STD. TOLERANCES:

[+1/16" / -1/16"]

Unless Otherwise Specified
All Drawing Units are In
INCHES

Pg4

STEP 4: Install the locking bracket using 2 1/4"x2" hex bolts and 1/4" Lock Nuts.

Note bracket orientation

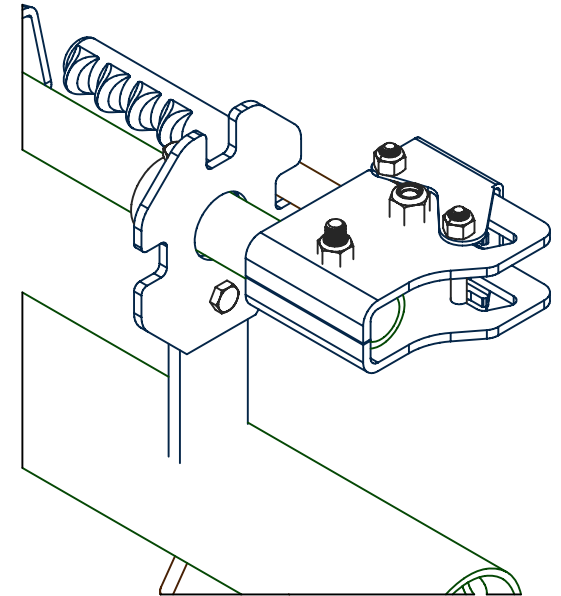
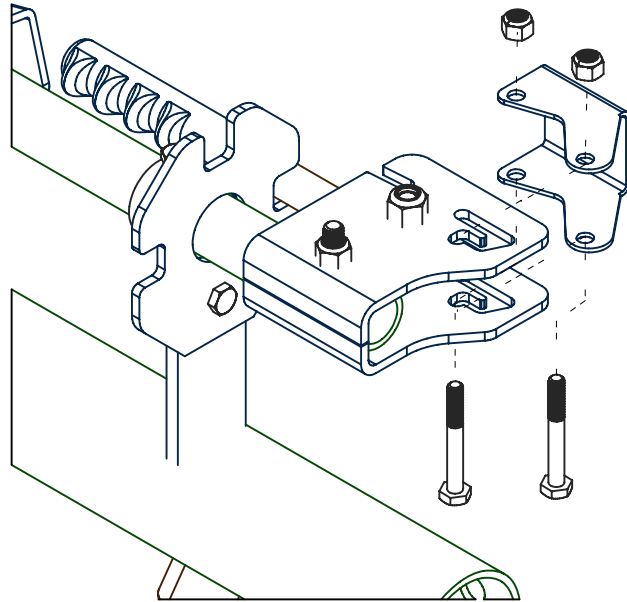

PUTTING INNOVATION TO WORK

PART DESC

180deg Self Lock Handle Instruction

DWG NO.

M0119B

Pg5

STD. TOLERANCES:

[+1/16" / -1/16"]

Unless Otherwise Specified
All Drawing Units are In
INCHES

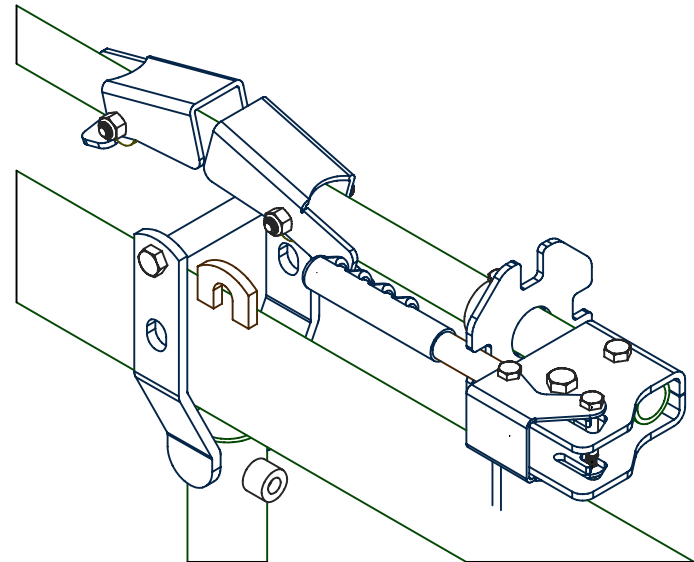
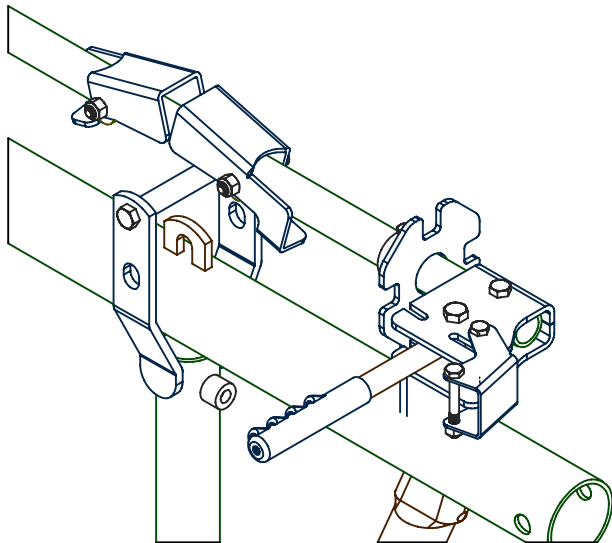
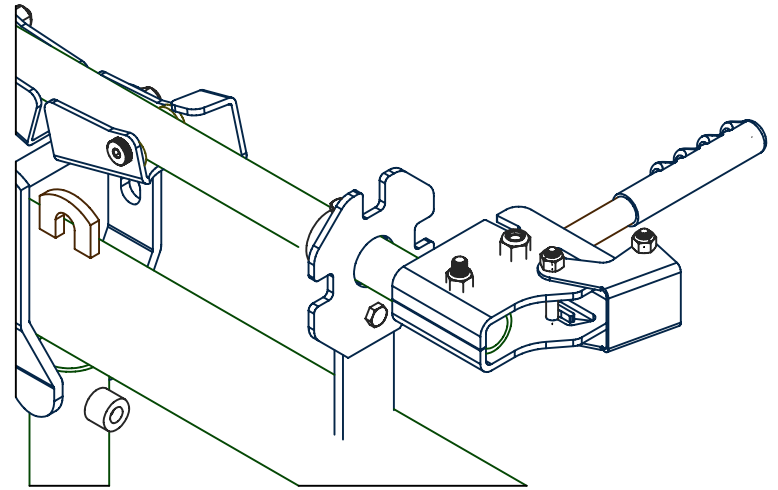
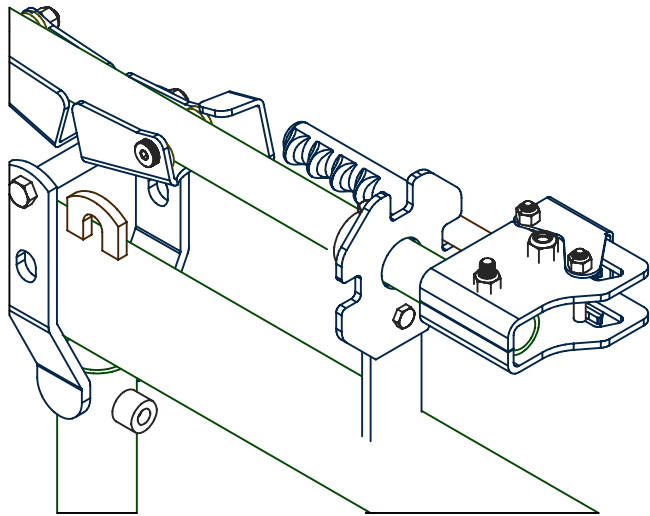

PART DESC
180deg Self Lock Handle Instruction

STD. TOLERANCES:
[+1/16" / -1/16"]

DWG NO.
M0119B

Unless Otherwise Specified
All Drawing Units are In
INCHES

NOTES:

REV DESC.

REVISION HISTORY

MODIFIED BY

DATE
3/25/2021 12:52:58 PM

CHECKED

Installation Instruction for handle turning 90deg due to structural post

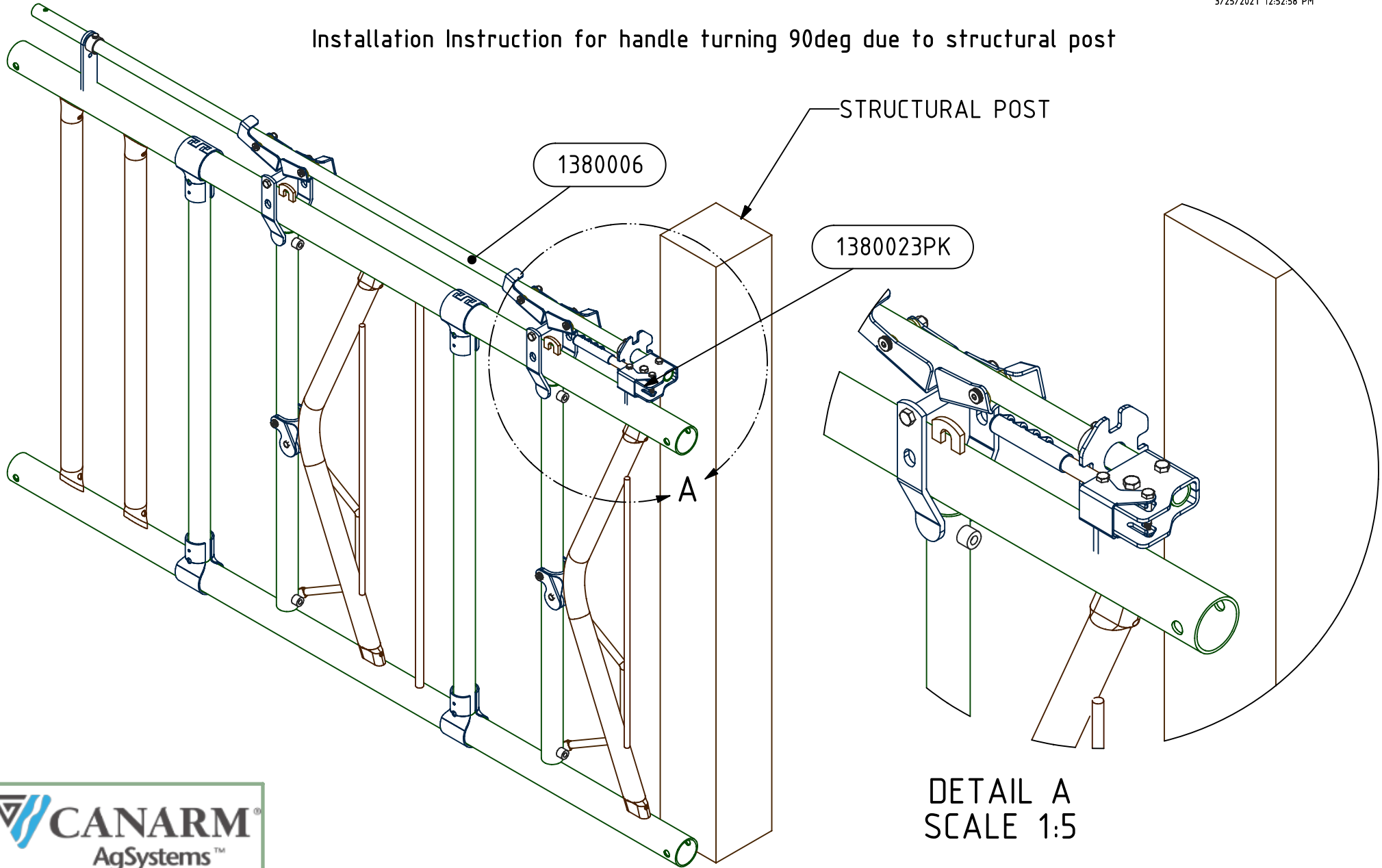

DETAIL A
SCALE 1:5



MATERIAL TYPE	Unknown Material
FINISH	
CURRENT REVISION	

INIT	DATE
	2/16/2021 12:24:24 PM

PART DESC	90deg Self Lock Handle Instruction	
DWG NO.	STD. TOLERANCES:	Unless Otherwise Specified
M0119A	[+1/16" / -1/16"]	All Drawing Units are In INCHES

THIRD ANGLE PROJECTION

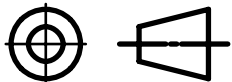

STEP 1: Redrill small existing hole in the turn rail with a 3/8" drill bit.
Slide Mount Bracket onto the turn rail and attach Mount Bracket using the 1/4"x1" Hex Bolt and 1/4" Lock Nut

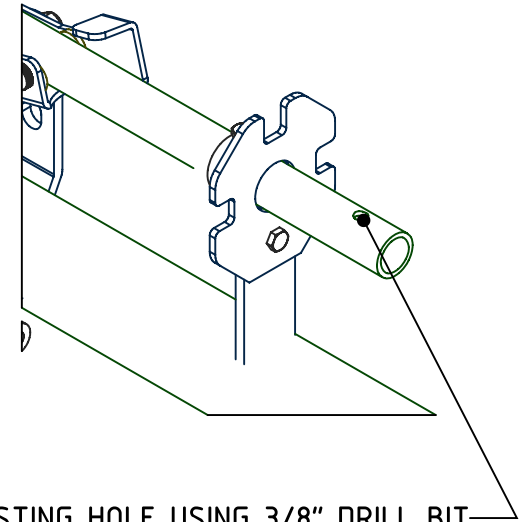
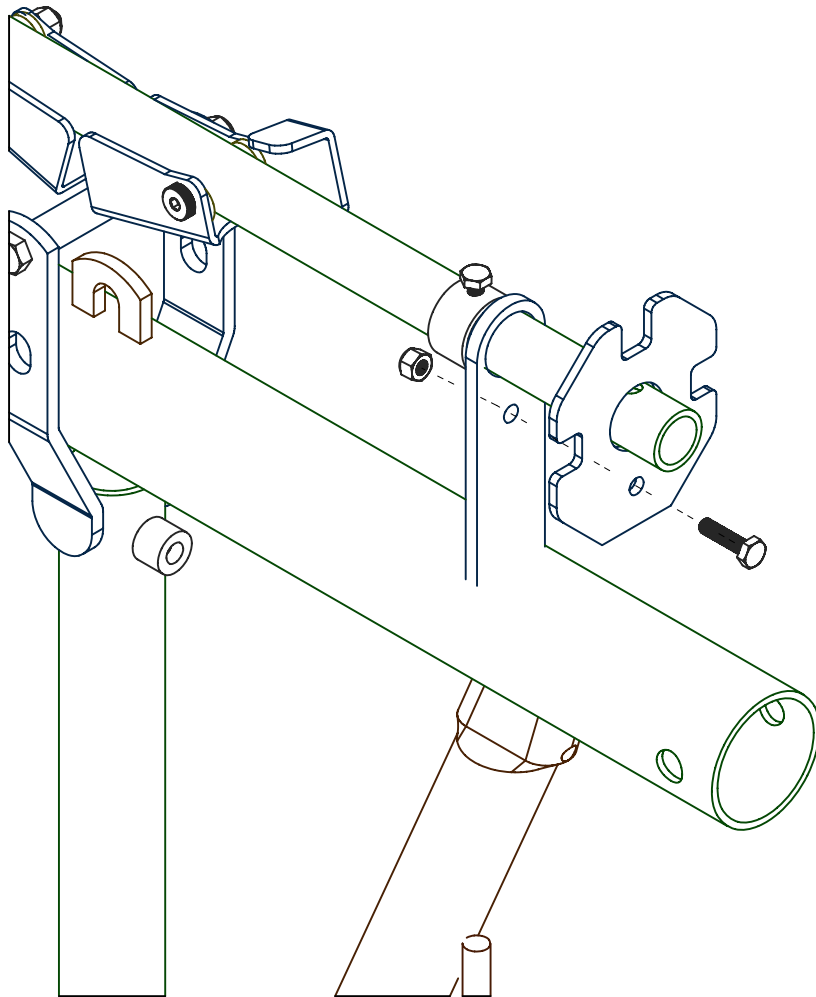

REDRILL SMALL EXISTING HOLE USING 3/8" DRILL BIT



PUTTING INNOVATION TO WORK

PART DESC

90deg Self Lock Handle Instruction

DWG NO.

M0119A

STD. TOLERANCES:
[+1/16" / -1/16"]

Unless Otherwise Specified
All Drawing Units are In
INCHES

Pg2

STEP 2: NOTE: Install brackets facing into the Feed Alley and with the flippers facing downward.

Loosely install the left and right bracket onto the turn rail using the 5/16"x2" Hex Bolt and 5/16" Lock Nut.
Do not tighten the bolt until the next step

Note bracket orientation

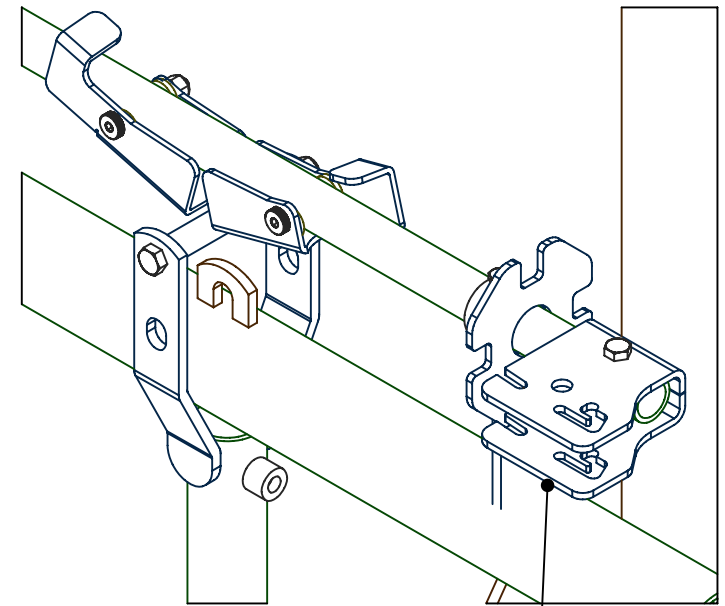
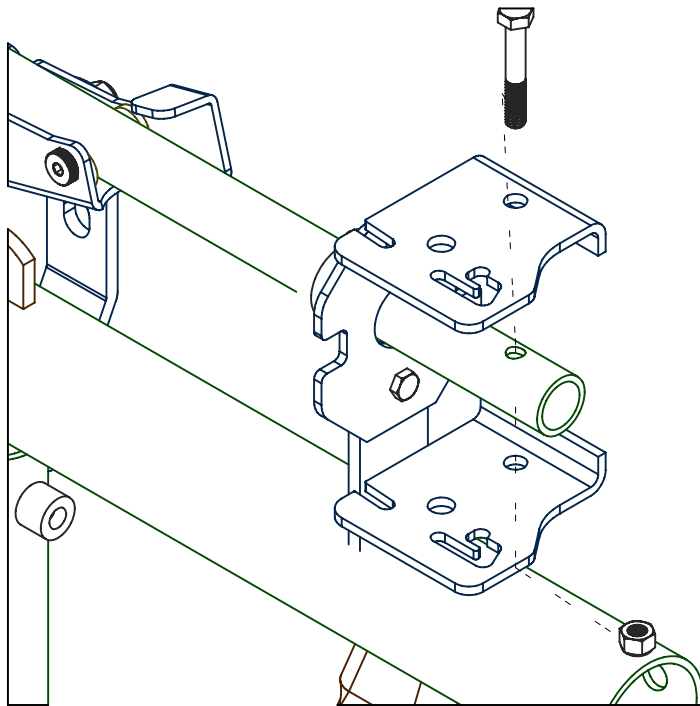

FEED ALLEY SIDE



PUTTING INNOVATION TO WORK

PART DESC

90deg Self Lock Handle Instruction

DWG NO.

M0119A

STD. TOLERANCES:

[+1/16" / -1/16"]

Unless Otherwise Specified
All Drawing Units are In
INCHES

Pg3

STEP 3: Loosely attach the handle between the left and right bracket using the 3/8"x2" Hex Bolt and 3/8" Lock Nut.
Fully tighten the 5/16" bolt from Step 2.
Tighten the 3/8" bolt until the handle is snug.

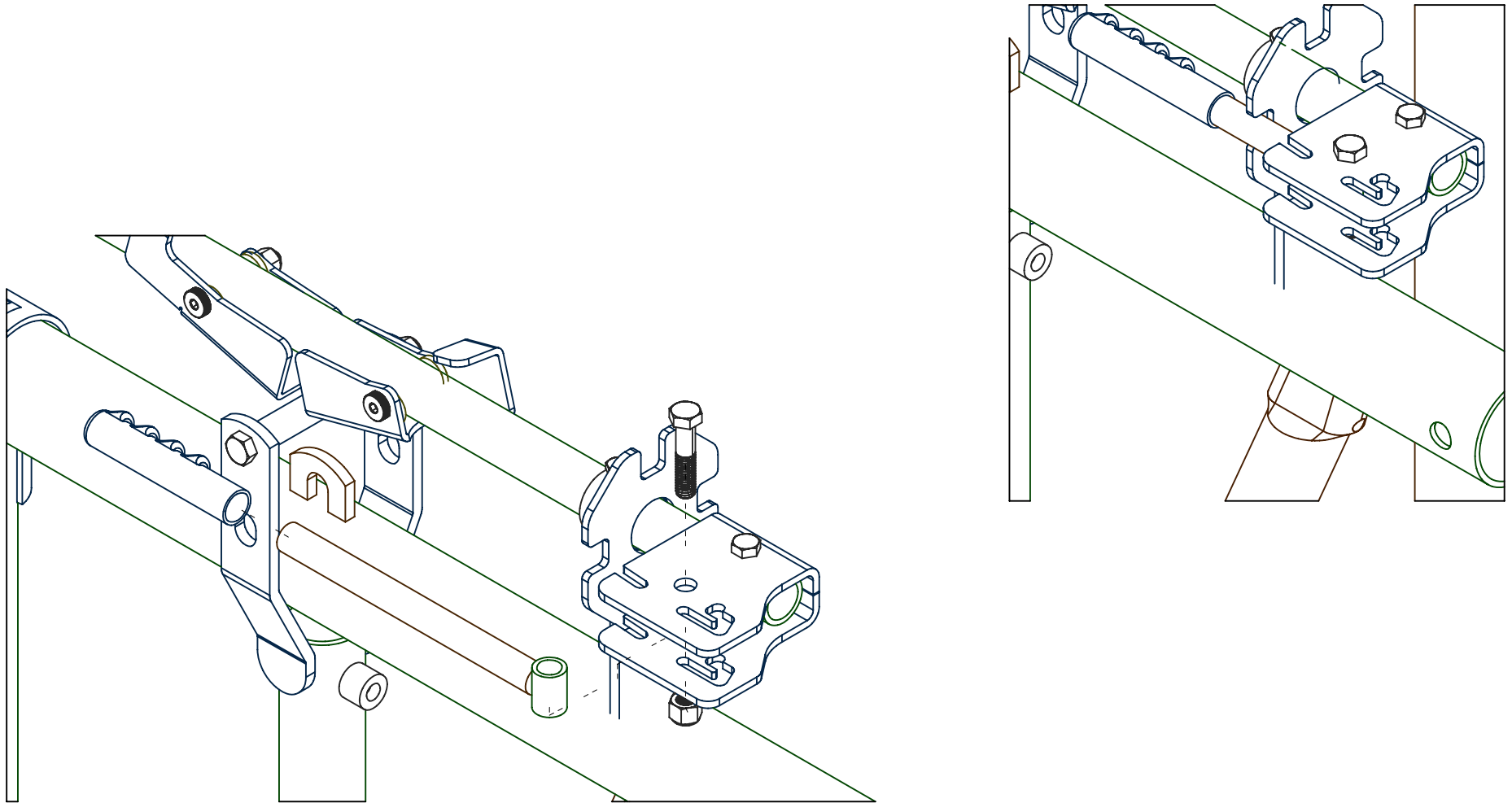

PUTTING INNOVATION TO WORK

PART DESC

90deg Self Lock Handle Instruction

DWG NO.

M0119A

STD. TOLERANCES:

[+1/16" / -1/16"]

Unless Otherwise Specified
All Drawing Units are In
INCHES

STEP 4: Install the locking bracket using 2 1/4"x2" hex bolts and 1/4" Lock Nuts.

Note bracket orientation

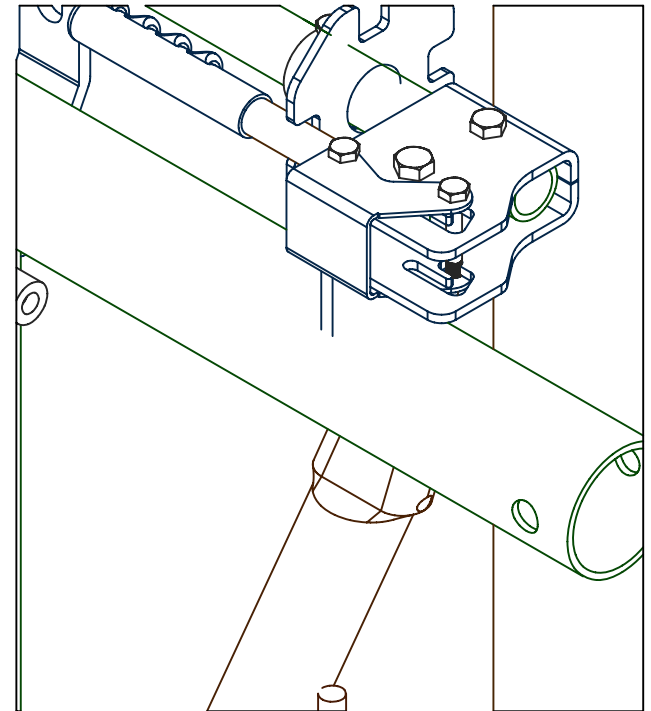
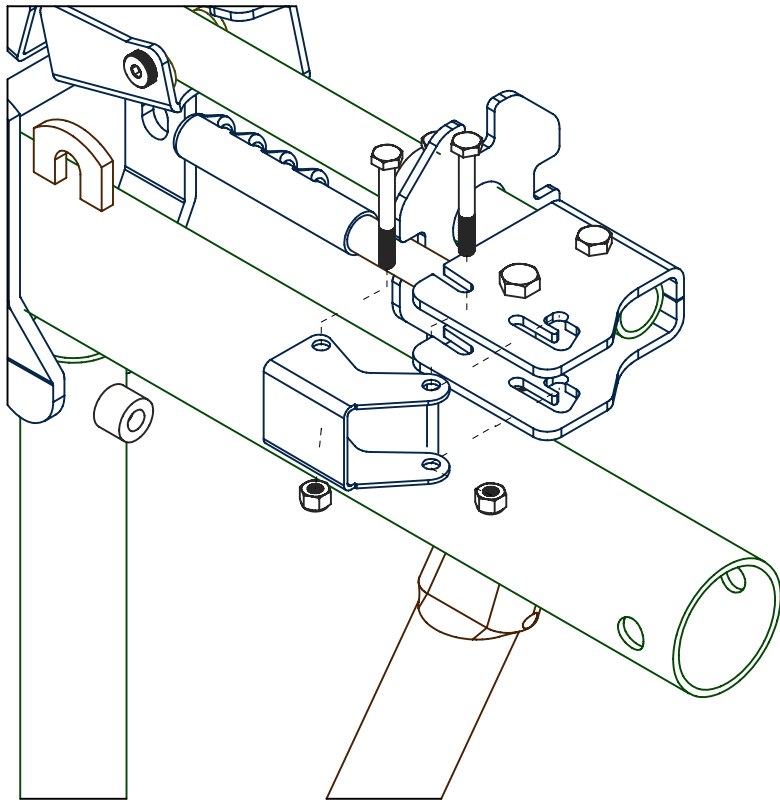

PUTTING INNOVATION TO WORK

PART DESC

90deg Self Lock Handle Instruction

DWG NO.

M0119A

Pg5

STD. TOLERANCES:

[+1/16" / -1/16"]

Unless Otherwise Specified
All Drawing Units are In
INCHES

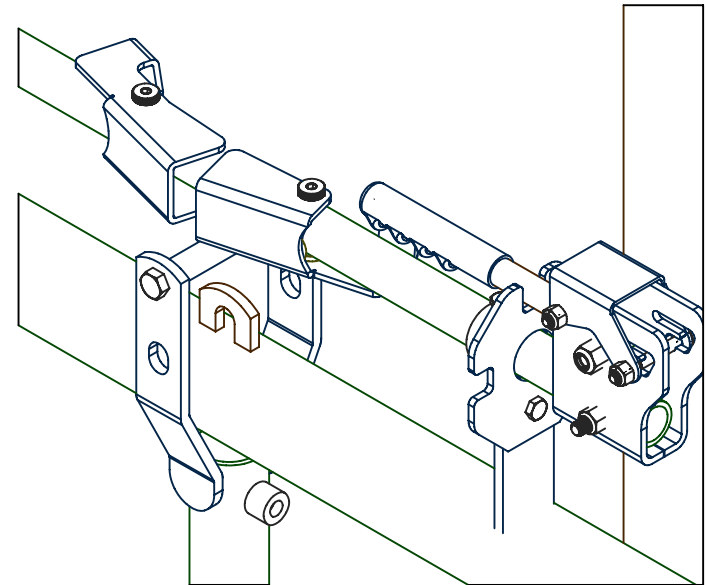
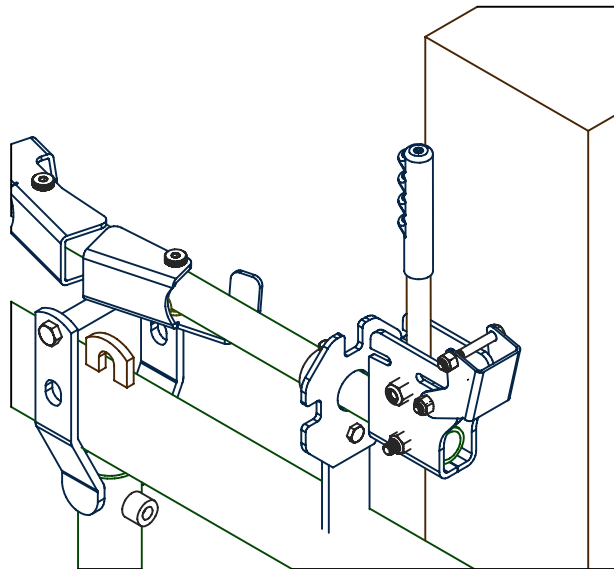
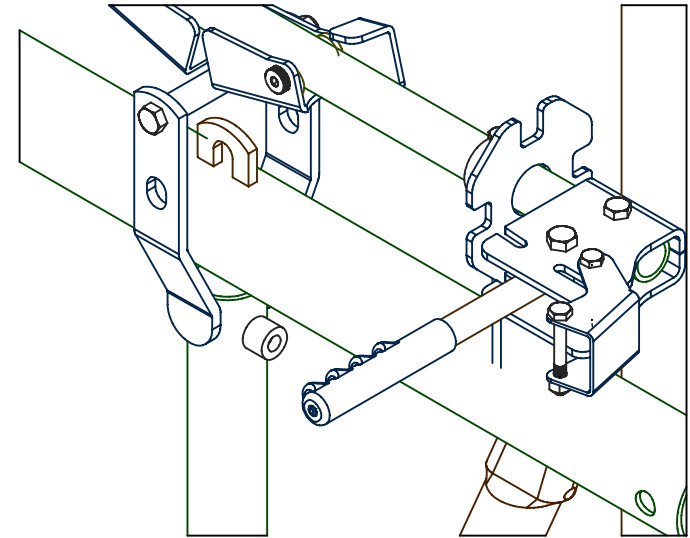
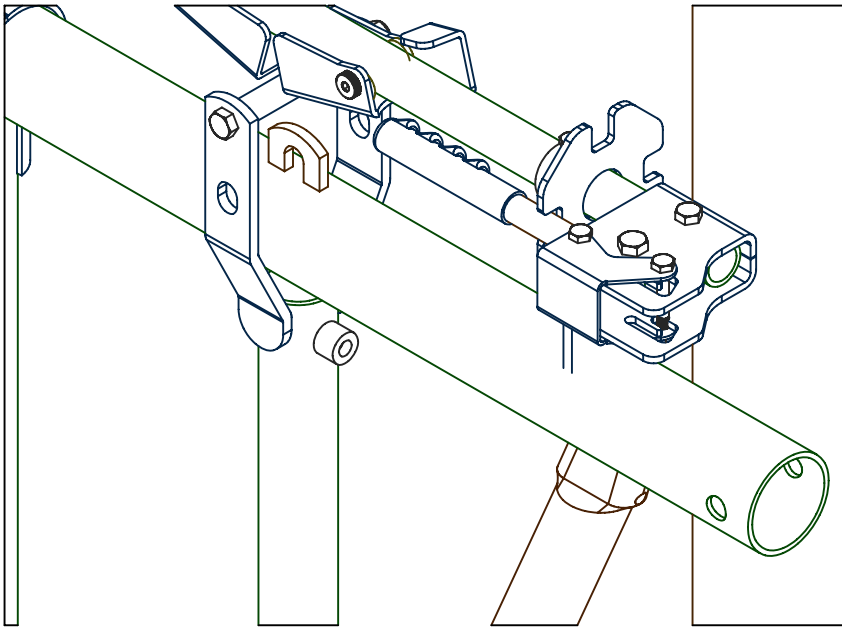

PUTTING INNOVATION TO WORK

PART DESC

90deg Self Lock Handle Instruction

DWG NO.

M0119A

STD. TOLERANCES:

[+1/16" / -1/16"]

Unless Otherwise Specified
All Drawing Units are In
INCHES