

Questions or Concerns Contact At The Following Phone Numbers Before
Returning Product To The Store:

1-800-265-1833 (English) / 1-800-567-2513 (French)

Monday through Friday 8:00 AM to 5:00 PM E.S.T.



INSTRUCTIONS PERTAINING TO RISK OF FIRE OR INJURY
TO PERSONS READ ALL INSTRUCTIONS

**IMPORTANT SAFETY
INSTRUCTIONS**
SAVE THESE INSTRUCTIONS

TOOLS AND MATERIALS REQUIRED:



Phillips
Screwdriver



Wire Cutters



Pliers



Wrench

Wiring supplies
as required by
local electrical
code

CAUTIONS:

1. Installation, Operating and Safety Instructions - Instructions for installation and use of this product are provided by the manufacturer.
2. To reduce the risk of fire, do not install in a compartment smaller than 12 inches by 12 inches by 12 inches".
3. For under cabinet or shelf mount only.

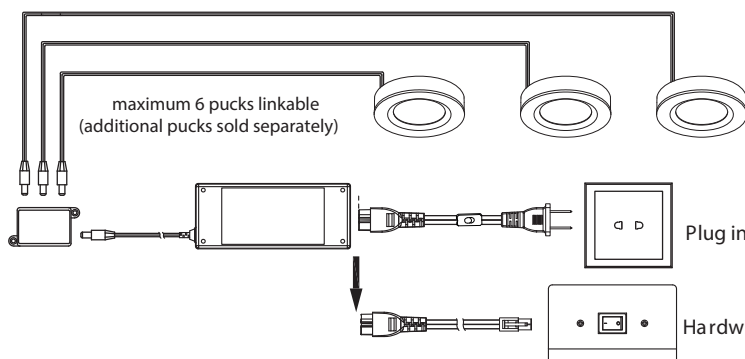

1. Turn off all power to house electrical supply wire.
2. Wire Hardwire box to house electrical supply wire with strain relief supplied with hardwire box.
3. Plug driver into hardwire box.
4. Plug power block into supply wire from driver.
5. Plug LED puck light into power block.
6. Make sure all wires are secured correctly.

For hardwire box wire diagram please see page 2

Surface Mount Installation

Step 1

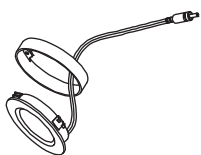

Using hands, separate outer shell from LED lamp.

Step 2

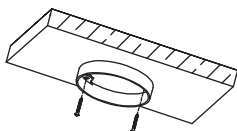

Using included hardware and a screw driver,
secure outer shell to cabinet surface.

Step 3

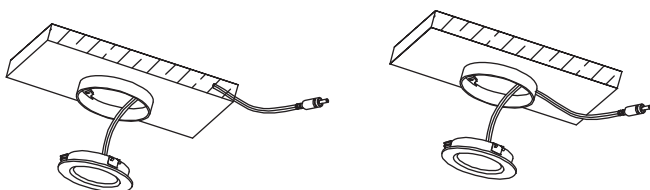

Feed connecting cord through a pre-drilled hole in the cabinet surface
or through the cut-out of the outer shell. Secure LED lamp into outer shell.

Recessed Installation

Step 1

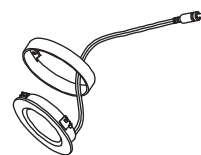

Using hands, separate outer shell from LED lamp.

Step 2

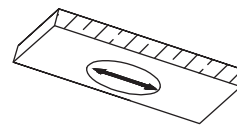

Cut out from the bottom of the cabinet a hole
using a 2.5" hole saw.

Step 3

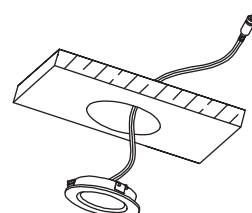

Feed connecting cord through the hole in
cabinet and secure LED lamp.

Hardwire Box and HUB Installation Instruction (JUNCTION BOX SOLD SEPERATELY)

1

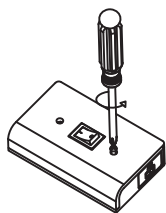

Unscrew the hardwire box

2

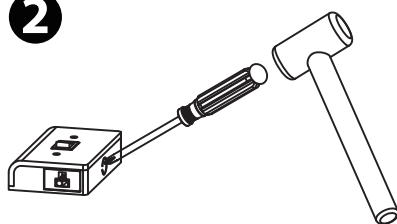

Remove the knock-out

3

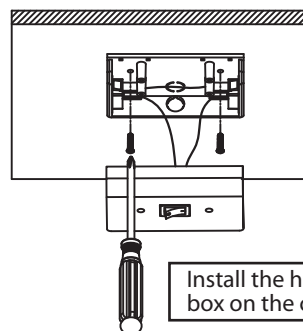

Install the hardwire box on the cabinet

4 Wire Guide

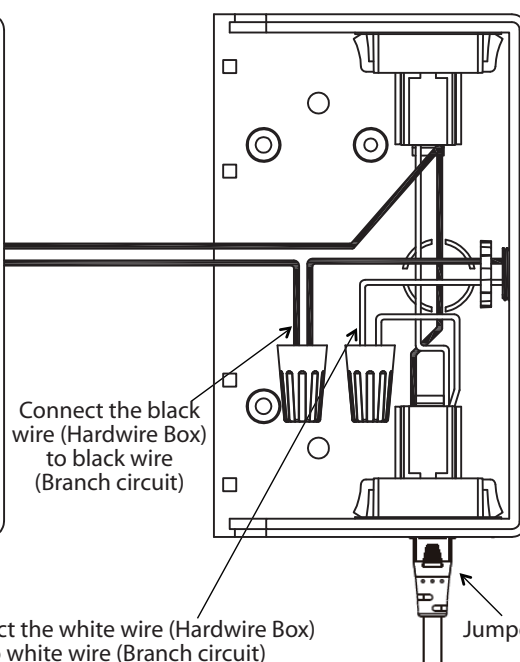
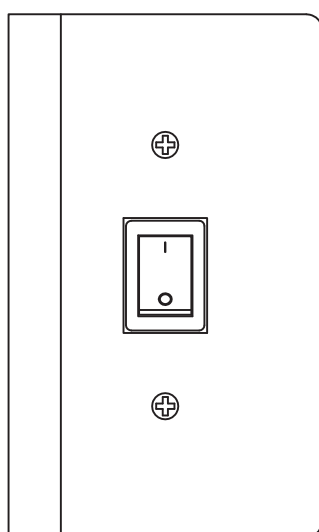

Connect the black wire (Hardwire Box) to black wire (Branch circuit)

Connect the white wire (Hardwire Box) to white wire (Branch circuit)

Strain Relief

Install the strain relief on the hardwire box

Jumper Cable to Connect to Fixture

5

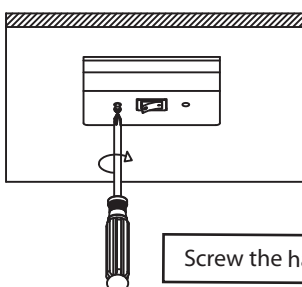

Screw the hardwire box

6

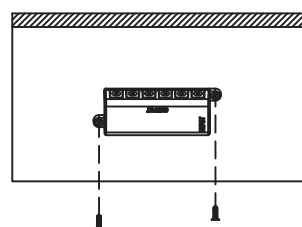

Install the HUB on the cabinet