

BUCKET FANS



BUCKET FAN

BUCKET FAN WHISPER

Bucket Fans are used for equalizing the floor-to-ceiling temperature. This provides a more comfortable thermal environment for occupants, while at the same time reducing energy costs. In the cold months the hot air at the roof is gently directed back down to the floor where it is needed. During the warm months in buildings that have air conditioning, Bucket Fans help push the cold air coming from the registers at the ceiling down to occupant level.

FEATURES

- For use in commercial, educational, government, or industrial settings with 15' to 30' plus ceilings.
- Fan casing is made of steel with polymeric coating, while impeller is made of aluminum.
- Asynchronous motor on ball bearings
- Thermally protected
- Speed controllable
- Easy to install
- Quiet operation
- Hanging/Safety Cable
- Two year warranty

HOW TO CALCULATE THE NUMBER OF BUCKET FANS YOU NEED

To enjoy the full benefit of destratification the accepted rule of thumb is to "turn the air" between one and two times an hour.

To determine how many Bucket Fans are needed use this formula:

- 1) $L \times W \times H = V$ (Length x Width x Height = Air Volume in Building)
- 2) $V / \text{CFM of the Bucket Fan} / 60$ (converts CFM to CFH) = Number of Fans

For ceiling heights 15 ft - 20 ft use the Bucket Fan 420
 For ceiling heights 20 ft - 25 ft use the Bucket Fan 1055
 For ceiling heights 25 ft and over use the Bucket Fan 1460

EXAMPLE:

A building that has the following dimensions:
 125 ft long, 75 ft wide, and 20 ft high.

- 1) $125 \times 75 \times 20 = 187,500 \text{ cu. ft}$
- 2) $187,500 / 1055 / 60 = 2.96 \text{ fans}$

Always round up to the next number. In this example
 3 Bucket Fans would be needed.

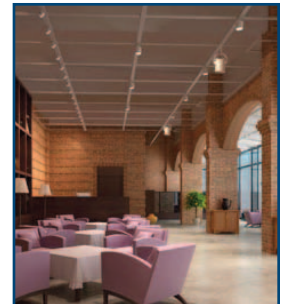

BUCKET FAN WHISPER NOISE LEVELS (SONES)

FAN HANGING HEIGHT	BUCKET FAN WHISPER 4420	BUCKET FAN WHISPER 1055	BUCKET FAN WHISPER 1460
20'	2.9	3.5	5.0
25'	2.6	3.1	4.7
30'	2.3	2.7	4.4
40'	2.0	2.3	4.1

PERFORMANCE SPECIFICATIONS

MODEL	RMP	SONES	MAX WATTS	MAX AMPS	AIRFLOW CFM (L/s)	AIRFLOW SPEED (DEPENDING ON DISTANCE POINT -ft- FPM)											VOLTS/HZ
						3	6	10	13	15	20	23	25	30	33	35	
BUCKET FAN 420	1700	9.8	60	0.51	420 (198)	378	270	220	156	90	60	20	—	—	—	120/60	
BUCKET FAN 1055	1675	11.3	94	0.8	1055 (498)	918	594	380	234	162	120	79	38	20	—	120/60	
BUCKET FAN 1460	1685	14.9	162	1.38	1460 (689)	1100	756	760	468	324	300	214	169	120	59	19	120/60

DIMENSIONS

MODEL	MEASUREMENTS					WEIGHT (LBS)
	ØD	ØD1	H	H1	A	
Bucket Fan 420	10 3/16"	13 7/16"	20 3/16"	15 3/16"	15 3/16"	6.6
Bucket Fan 1055	12 3/16"	15 7/16"	23 7/8"	17 3/16"	17 1/4"	11
Bucket Fan 1460	14 3/16"	17 7/16"	27 5/16"	20 5/16"	19 3/16"	12.3
Bucket Fan Whisper 420	15 1/8"	11 7/8"	24 5/8"	18 7/16"	17 15/16"	24.3
Bucket Fan Whisper 1055	17 1/16"	13 7/8"	27 5/8"	20 3/8"	19 15/16"	32
Bucket Fan Whisper 1460	19 1/16"	15 13/16"	30 9/16"	22 3/8"	21 7/8"	37.5

BUCKET FAN

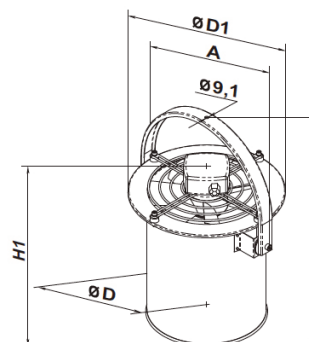

BUCKET FAN WHISPER

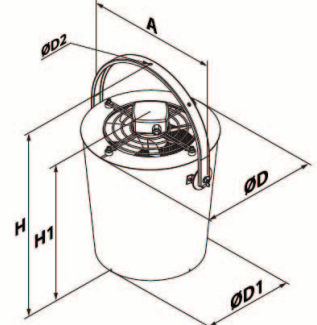

ACCESSORIES

- Variable Speed Control